

**KBC7005
MASON CURVED BENCH**

KBC7005
REV. 1
12/2/25

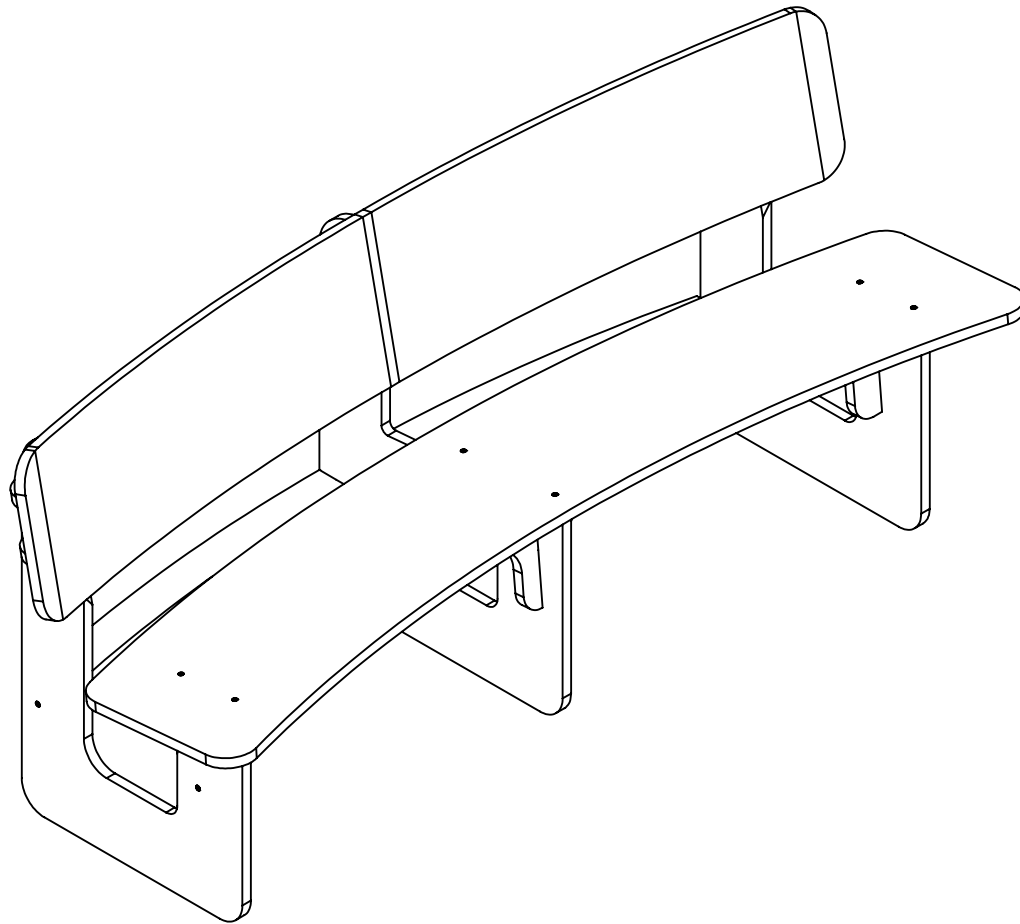

KBC7005 MASON CURVED BENCH

BACK REST
QTY. = 1

A

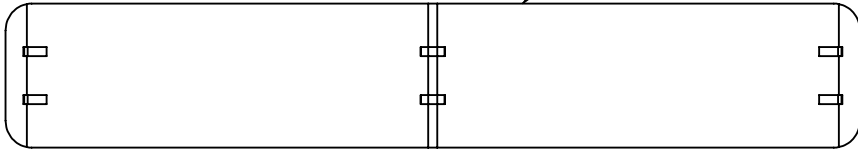

SEAT
QTY. = 1

B

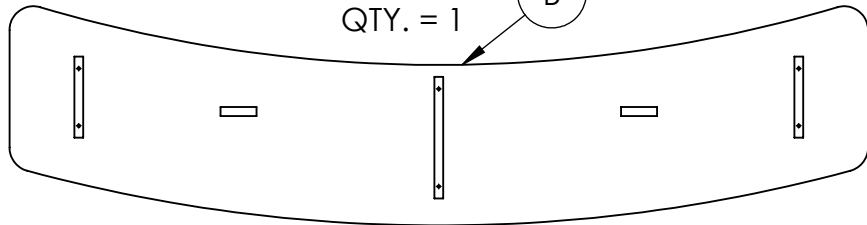

BACK SUPPORT
QTY. = 2

C

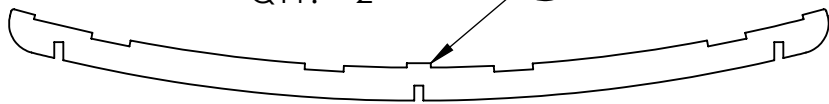

CENTER LEG
QTY. = 1

D

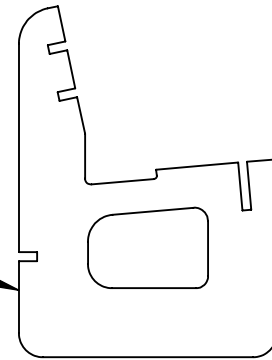

LEFT LEG
QTY. = 1

E

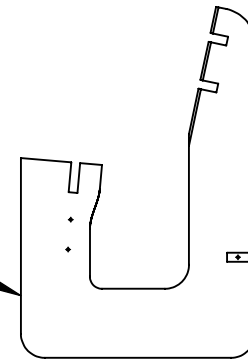

RIGHT LEG
QTY. = 1

F

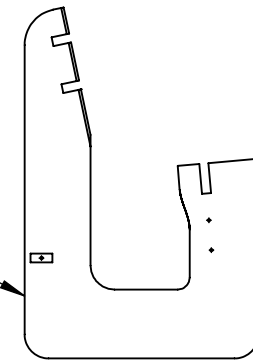

**PARTS & TOOLS
REQUIRED FOR
ASSEMBLY**

1/8

KBC7005 MASON CURVED BENCH

LEG STRETCHER SUPPORT
QTY. = 1

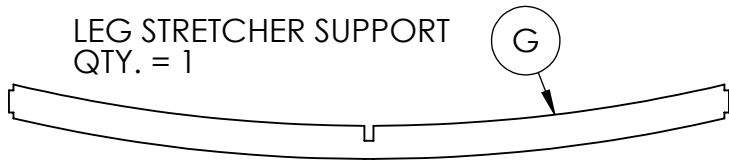

MOUNTING PLATE
QTY. = 4

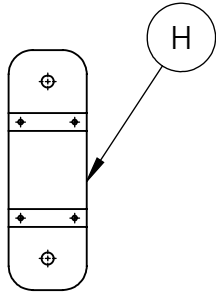

SEAT SUPPORT
QTY. = 1

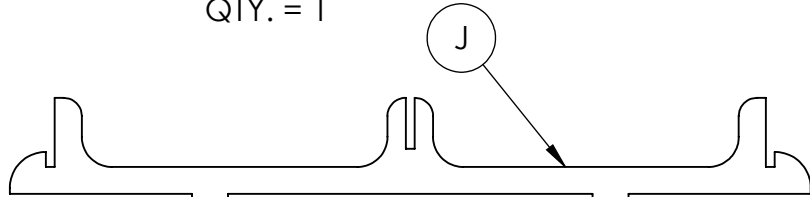

#10 X 2" DECK SCREW
QTY. = 28

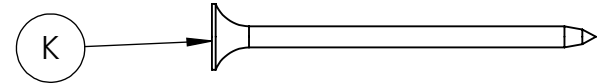

#10 X 2-1/2" DECK SCREW
QTY. = 6

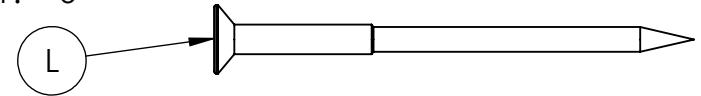

1/4" FLAT WASHER
QTY. = 8

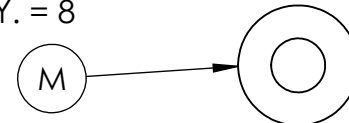

1/4"-20 X 1-1/4" BUTTONHEAD
SCREW
QTY. = 8

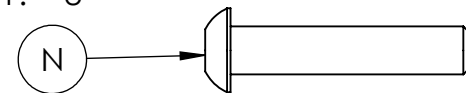

REQUIRED TOOLS (NOT INCLUDED)

6mm ALLEN WRENCH
#2 SQUARE DRIVE BIT

**PARTS NEEDED
FOR ASSEMBLY**

2/8

KBC7005 MASON CURVED BENCH

STEP 1: BEGIN BY STANDING UP THE CENTER LEG (D), AND SLIPPING THE SEAT SUPPORT (J) INTO THE SLOT. A RUBBER Mallet MIGHT BE NECESSARY TO FULLY SEAT THE TWO PARTS. THEN ENGAGE THE LEFT AND RIGHT LEGS (E & F) INTO THE OUTER SLOTS OF THE SEAT SUPPORT. MAKE SURE THE LONG SUPPORT PIECE IS FULLY SEATED INTO THE LEFT AND RIGHT LEGS. SECURE THE LEFT AND RIGHT LEGS USING (4) SCREWS (K) TOTAL. DRIVE THE SCREWS JUST UNTIL FLUSH - DO NOT OVER DRIVE THEM.

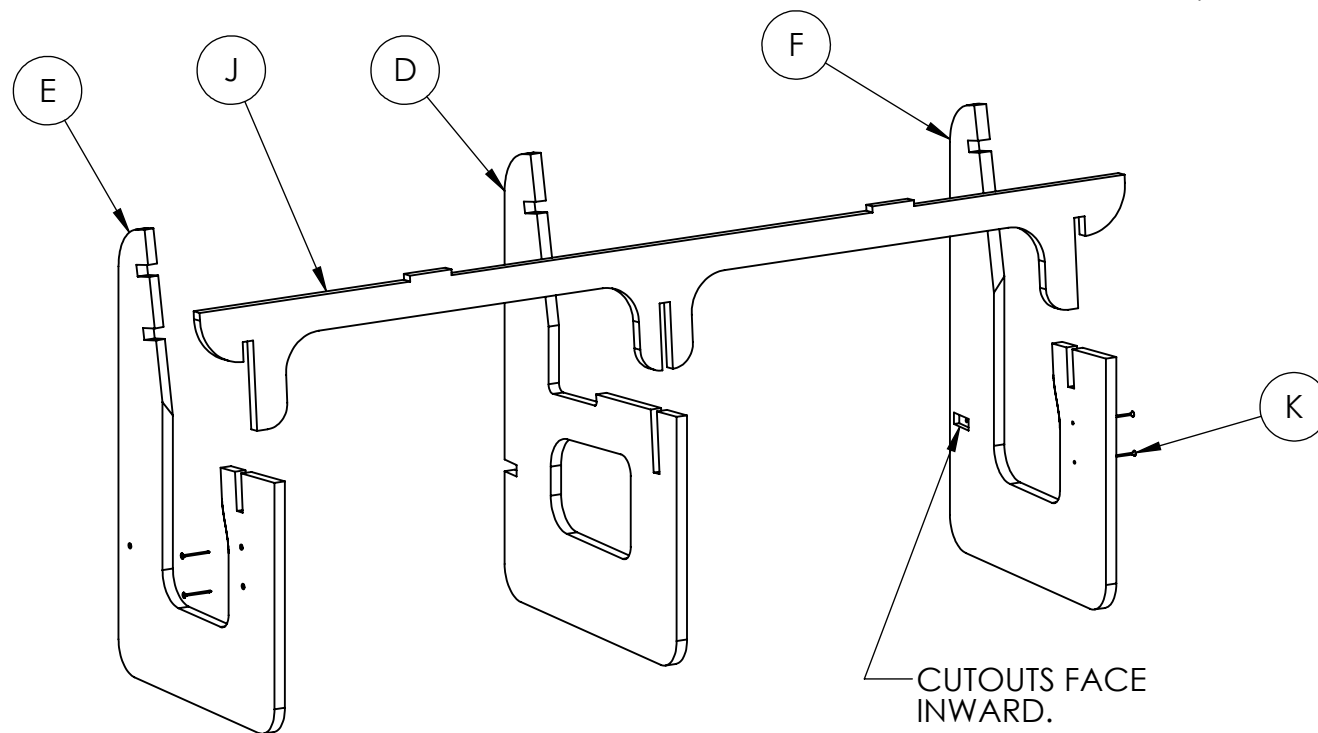

KBC7005 MASON CURVED BENCH

STEP 2: INSTALL THE LEG STRETCHER SUPPORT (G). THERE WILL BE ENOUGH FLEXIBILITY IN THE PARTS AT THIS POINT TO ENGAGE ONE END OF THE SUPPORT PIECE INTO THE LEFT OR RIGHT LEG. THEN WORK IN MIDDLE LEG, THEN THE OPPOSITE END. A RUBBER Mallet MIGHT BE NECESSARY TO FULLY SEAT THE PARTS INTO EACH OTHER. FINISH BY INSTALLING (1) #8 X 2" SCREW (K) INTO EACH END AS SHOWN, DRIVING THEM JUST UNTIL FLUSH.

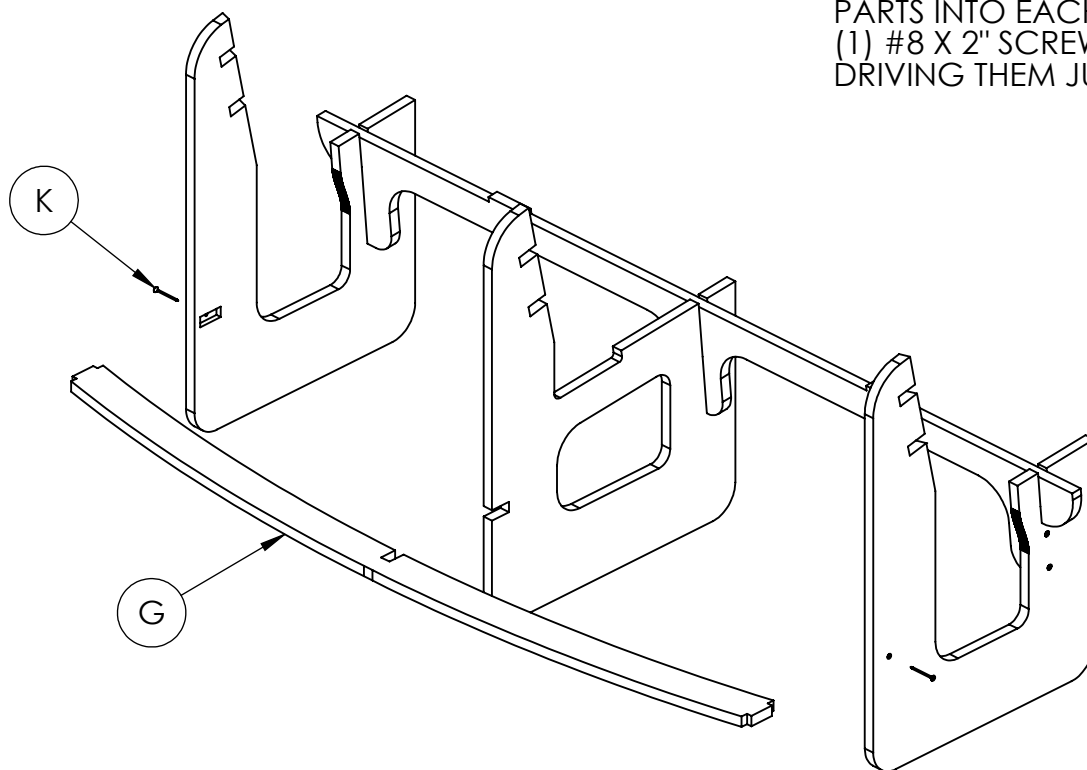

**ATTACH LEG
SUPPORT**

4/8

KBC7005 MASON CURVED BENCH

STEP 3: INSTALL THE SEAT (B) WITH THE CUTOUTS FACING DOWNWARD. THESE WILL ENGAGE THE UPWARD FACING TABS IN THE SEAT SUPPORT. A RUBBER Mallet MAY BE NECESSARY TO FULLY SEAT THE PARTS. INSTALL (6) #10 X 2" SCREWS (K) AS SHOWN.

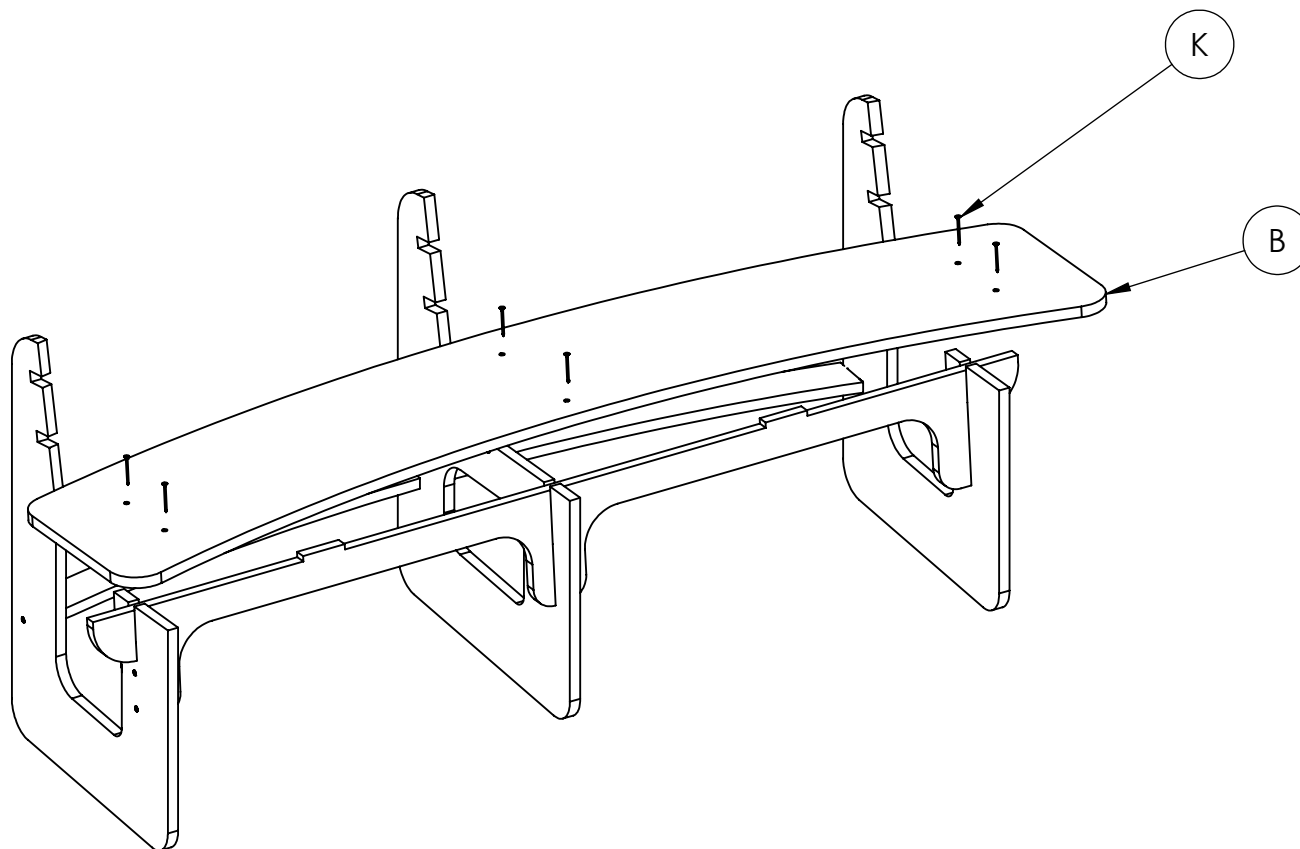

**ATTACHING
SEAT**

5/8

KBC7005 MASON CURVED BENCH

STEP 4: INSTALL (2) BACK SUPPORT PIECES (C) INTO THE SLOTS IN THE 3 LEG SECTIONS. FULLY SEAT WITH RUBBER Mallet IF NECESSARY. SECURE USING (6) #10x2-1/2" DECK SCREWS (L).

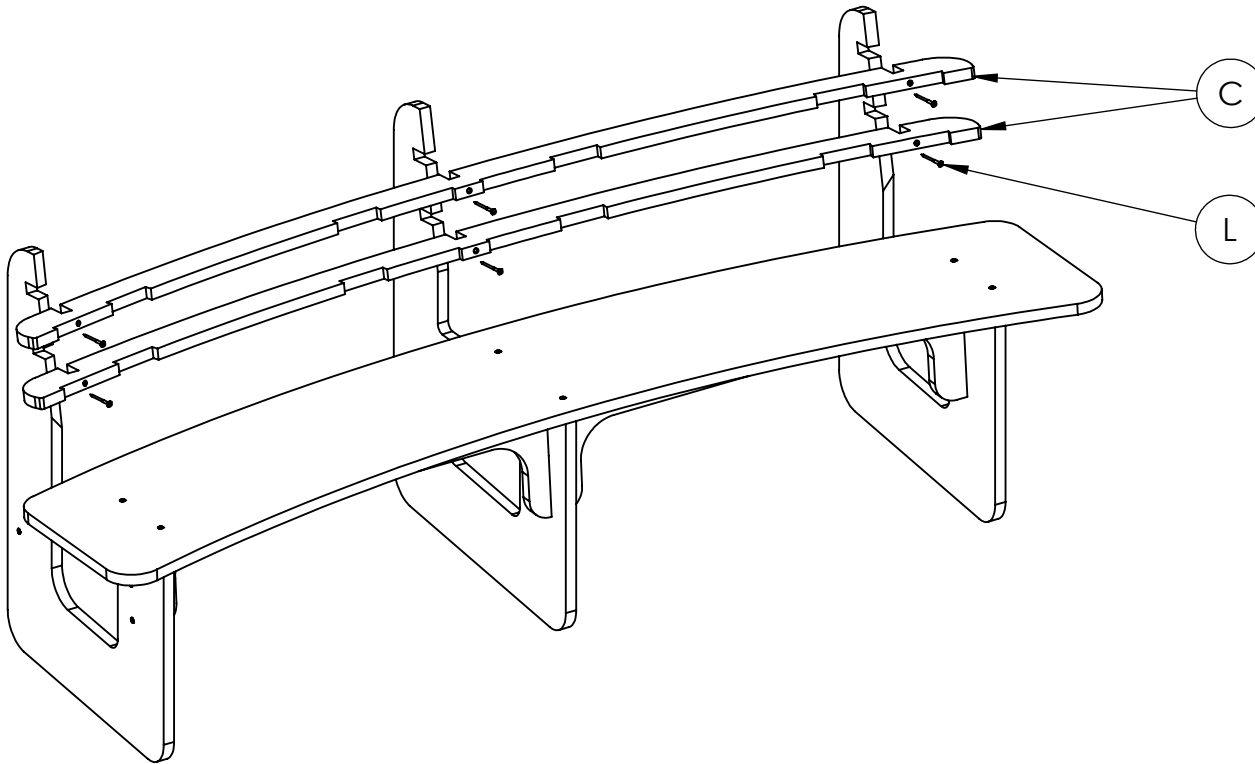

**ATTACHING BACK
REST SUPPORTS**

6/8

KBC7005 MASON CURVED BENCH

STEP 5: INSTALL THE (4) MOUNTING PLATES (H) TO THE BACK SUPPORTS USING (4) SCREWS (K) EACH. AS ALWAYS, LIGHT TAPS WITH A RUBBER Mallet MIGHT BE NECESSARY.

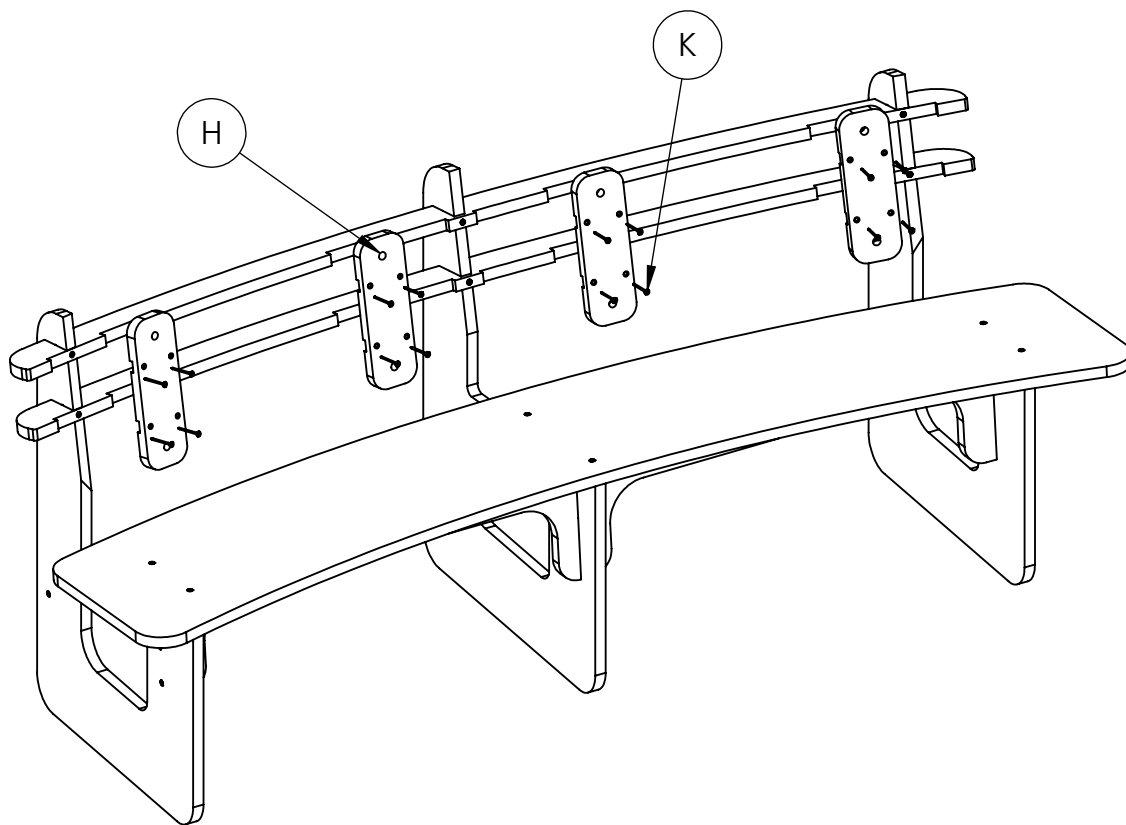

KBC7005 MASON CURVED BENCH

STEP 6: THIS STEP REQUIRES TWO PEOPLE AND A LARGE CLAMP. SINCE THE BACK IS FLAT, AND IT'S GETTING MOUNTED TO A FRAMEWORK THAT IS CURVED, IT WILL TAKE ON A BEND AS IT IS FORCED INTO PLACE. POSITION THE BACK (A) UP AGAINST SUPPORTS. USING A LARGE CLAMP NEAR THE CENTER OF THE BACK, SQUEEZE THE MIDDLE OF THE BACK UP AGAINST THE MIDDLE LEG. AS IT BEGINS TO BEND INTO PLACE, GUIDE THE TABS ON THE LEGS INTO THE CUTOUTS IN THE BACKREST. WHEN THE PIECES ARE DRAWN TOGETHER ENOUGH, INSTALL THE (8) FLAT WASHERS (M) AND THE (8) BUTTONHEAD SCREWS (N) THROUGH THE MOUNTING PLATES AND INTO THE THREADED INSERTS IN THE BACKREST. TIGHTEN WITH ALLEN WRENCH.

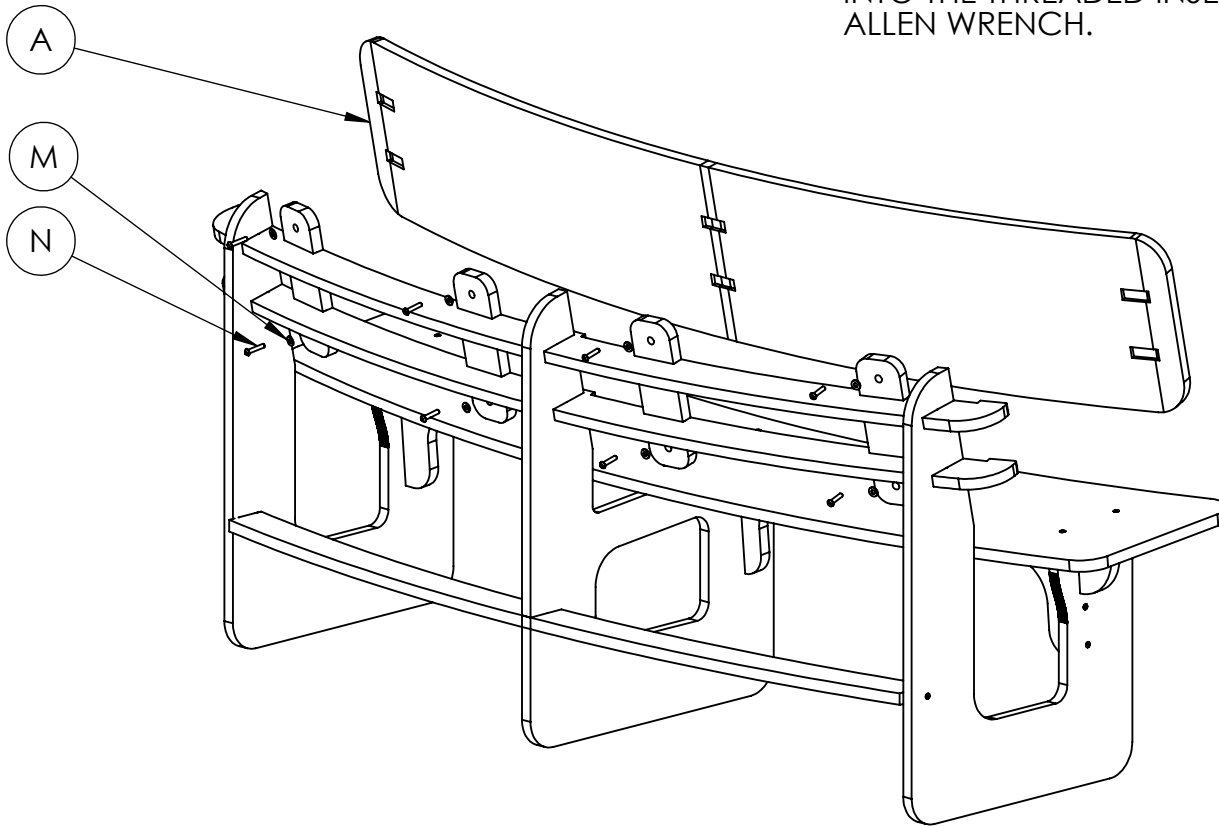

KBC7005 MASON CURVED BENCH

REV #1 12/2/25

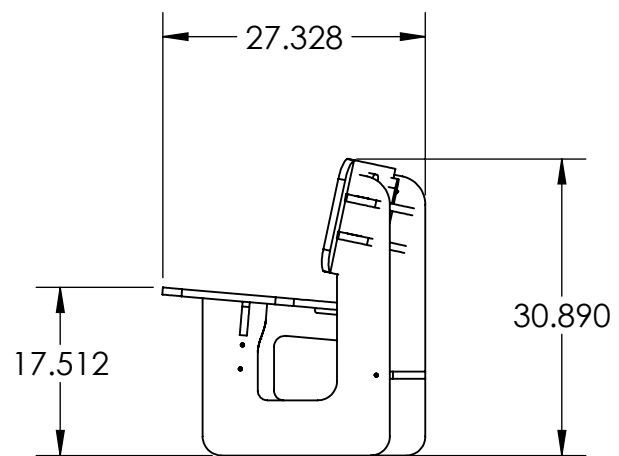
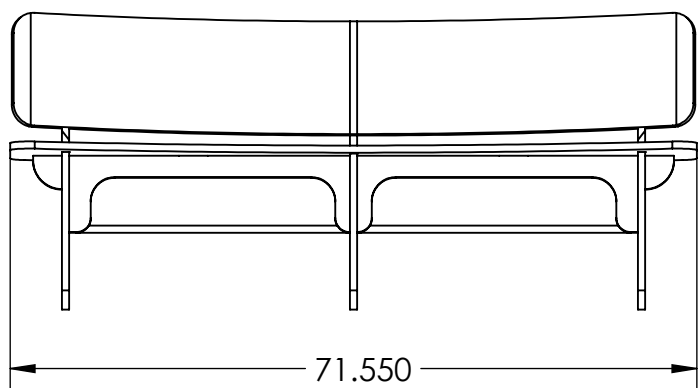
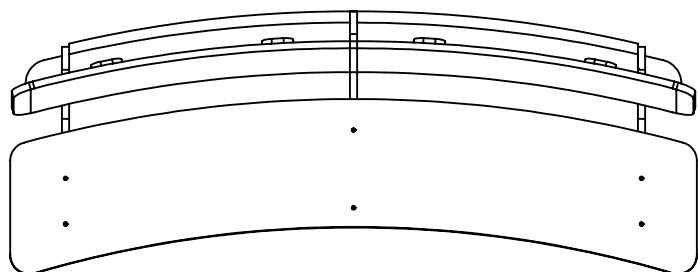

NOTE: ALL MATERIAL RECYCLED PLASTIC UNLESS NOTED

ALL DIMENSIONS ARE SHOWN IN INCHES