

BAR HEIGHT STOOL INSTRUCTIONS

CF1027

REV# 2
9/12/22

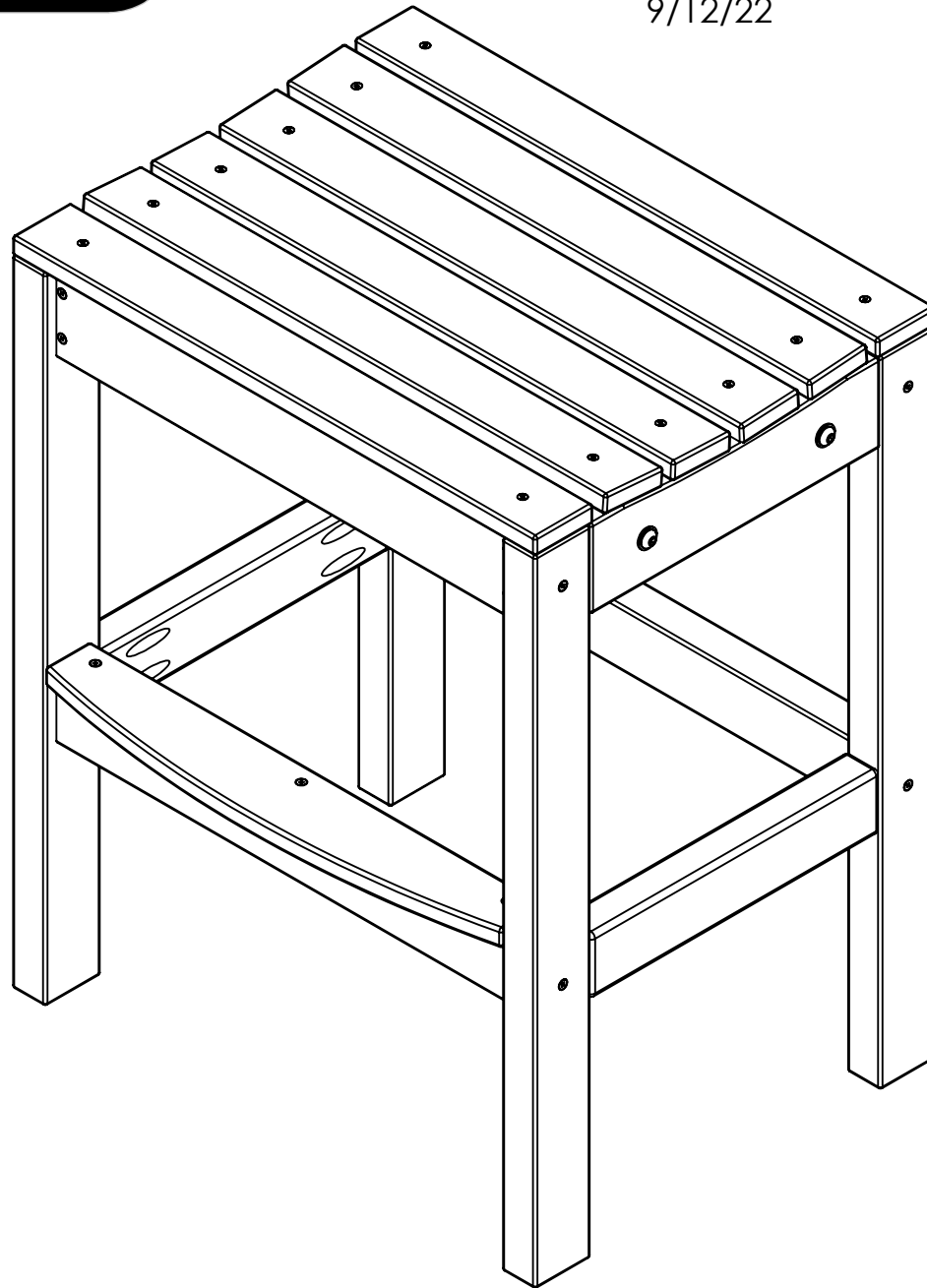

BAR HEIGHT STOOL INSTRUCTIONS

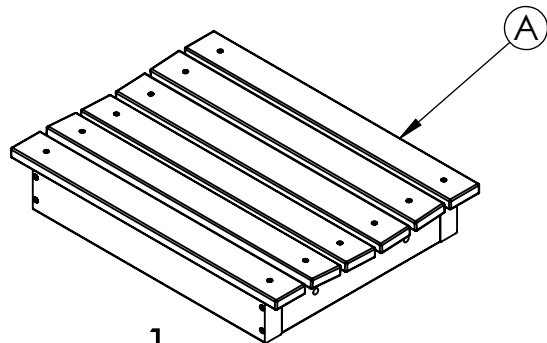

1
Seat Assembly
ACF-A0024

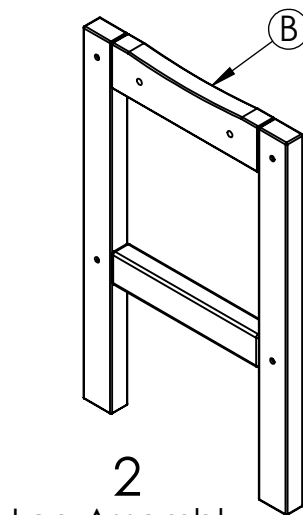

2
Leg Assembly
ACF-A0025

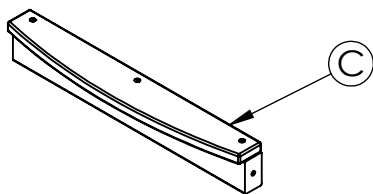

1
Lower Foot
Rest Assembly
ACF-A0067

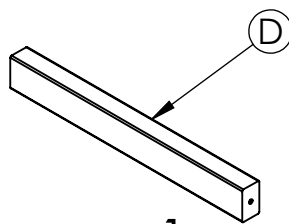

1
Rear Leg Brace
ACF-P0082

HARDWARE



4
3/8" x 3" Button Head Cap Screws
SCBH037C300188

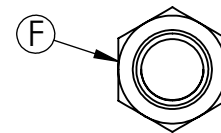

4
3/8" Hex Nuts
NNYL037CNUT188

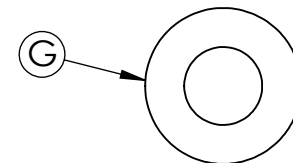

8
3/8" Flat Washer
WUSS037WAS188

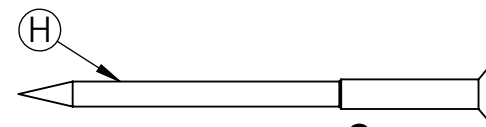

8
#10 x 2.5 Flat Head Screw
DSSF010C250188

REQUIRED TOOLS (NOT INCLUDED)

- POWER DRILL
- 7/32 ALLEN WRENCH
- 9/16 WRENCH
- #2 SQUARE DRIVE

**NOTE: IT IS IMPORTANT TO KEEP ALL
SCREWS LOOSE DURING ASSEMBLY
UNTIL ENTIRE BENCH IS ASSEMBLED**

**HARDWARE &
TOOLS REQUIRED
FOR ASSEMBLY**

2/5

BAR HEIGHT STOOL INSTRUCTIONS

STEP 1

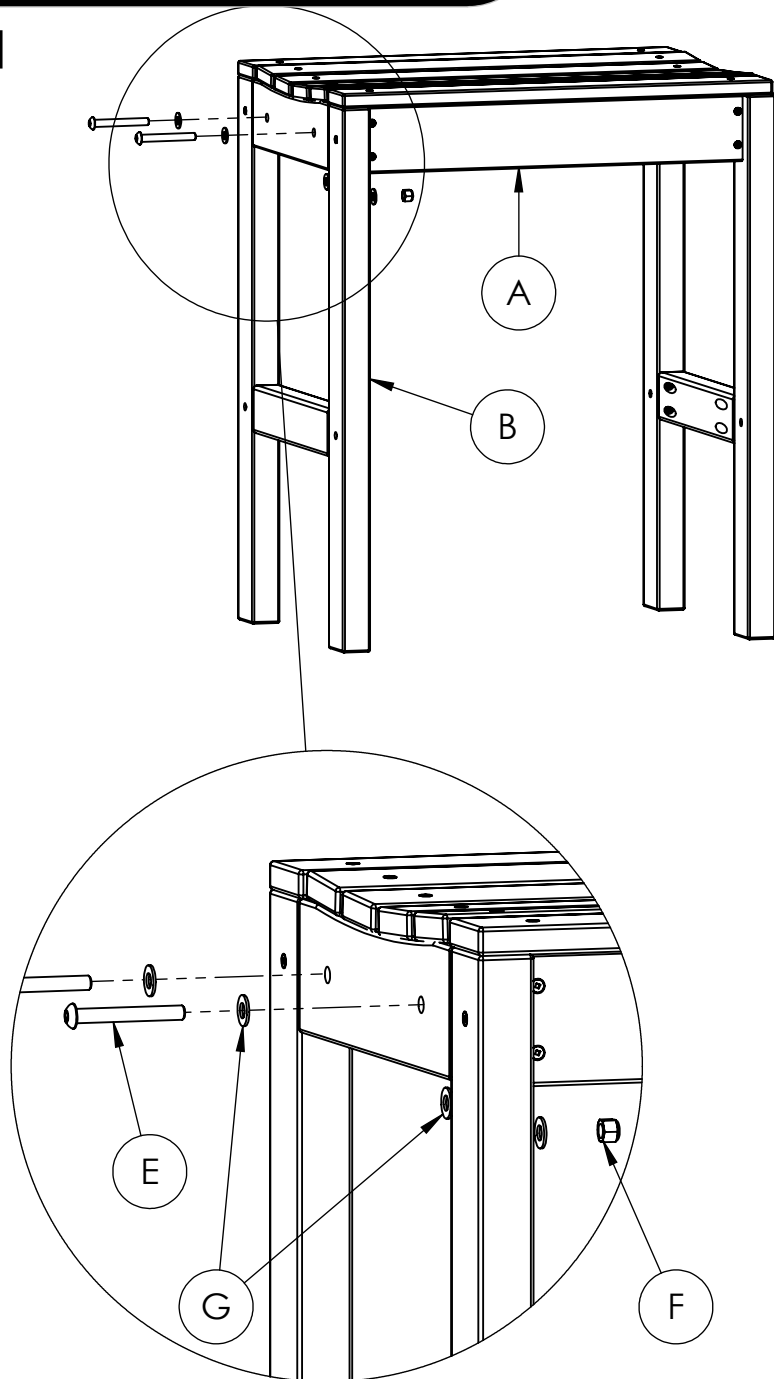

STEP 2

PRE-MARKED
HOLE LOCATIONS

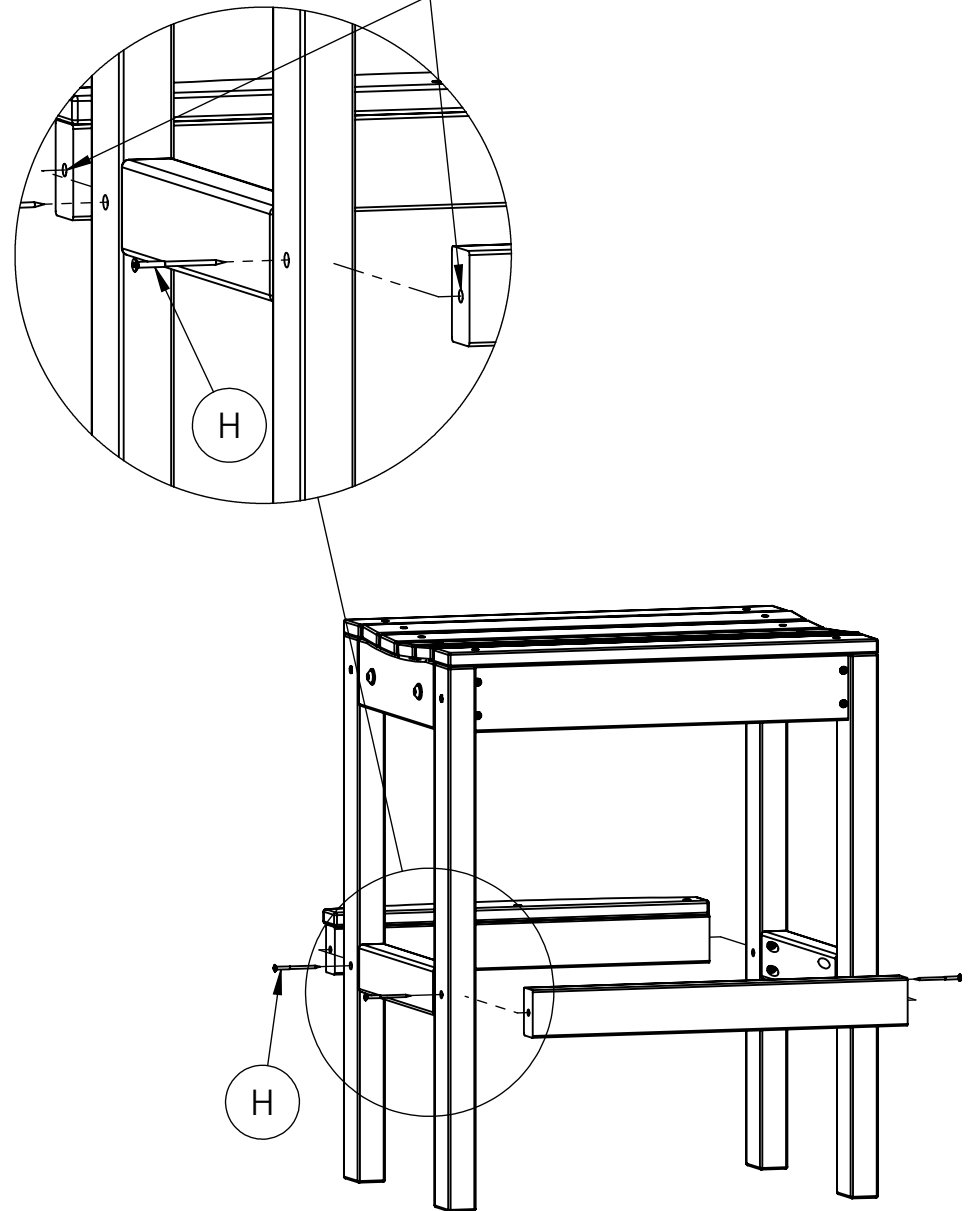

ASSEMBLY

3/5

BAR HEIGHT STOOL INSTRUCTIONS

STEP 3

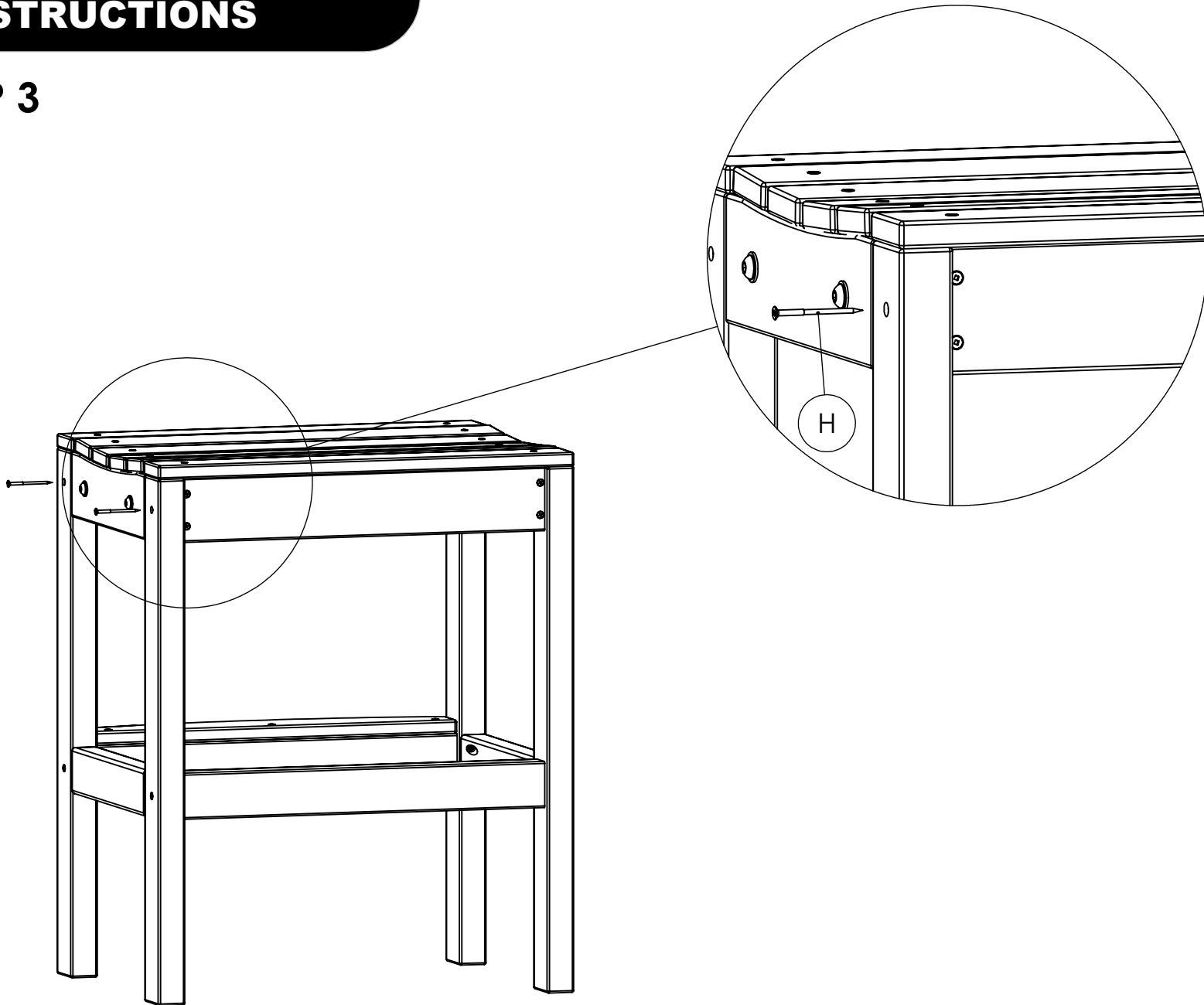

BAR HEIGHT STOOL SPECIFICATIONS

CF1027

REV# 2
9/12/22

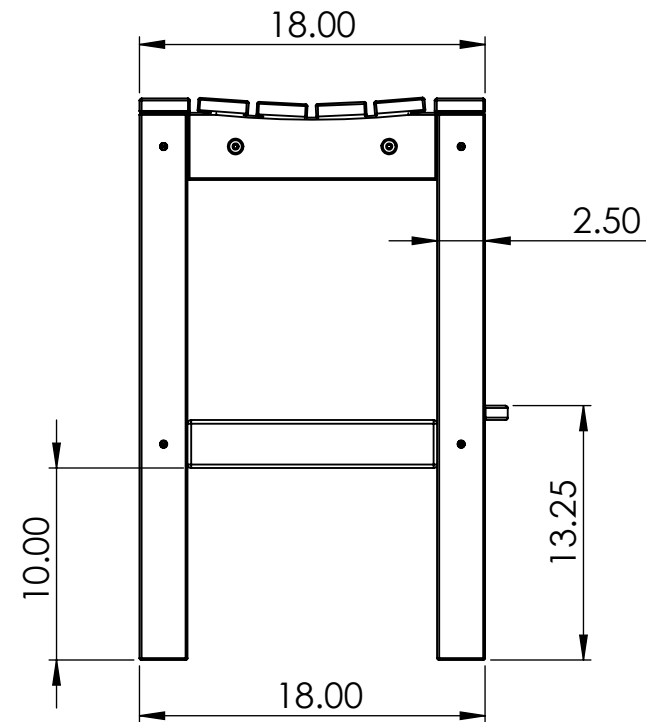
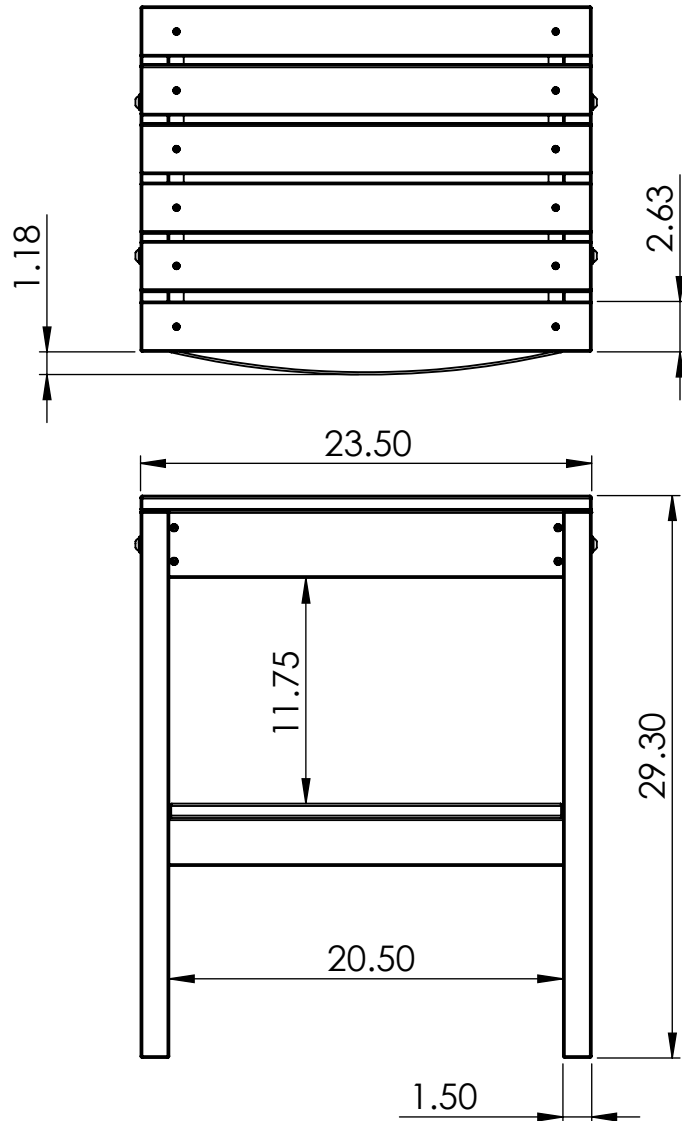
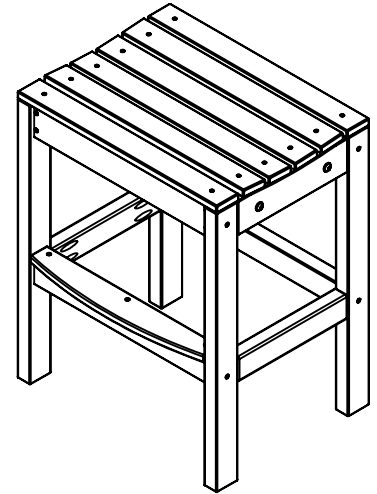

CONSTRUCTION MATERIALS:
Recycled Plastic
HARDWARE:
Stainless Steel

ALL DIMENSIONS SHOWN IN INCHES