

---

---

# Installation Instructions

## Prefabricated Shelter

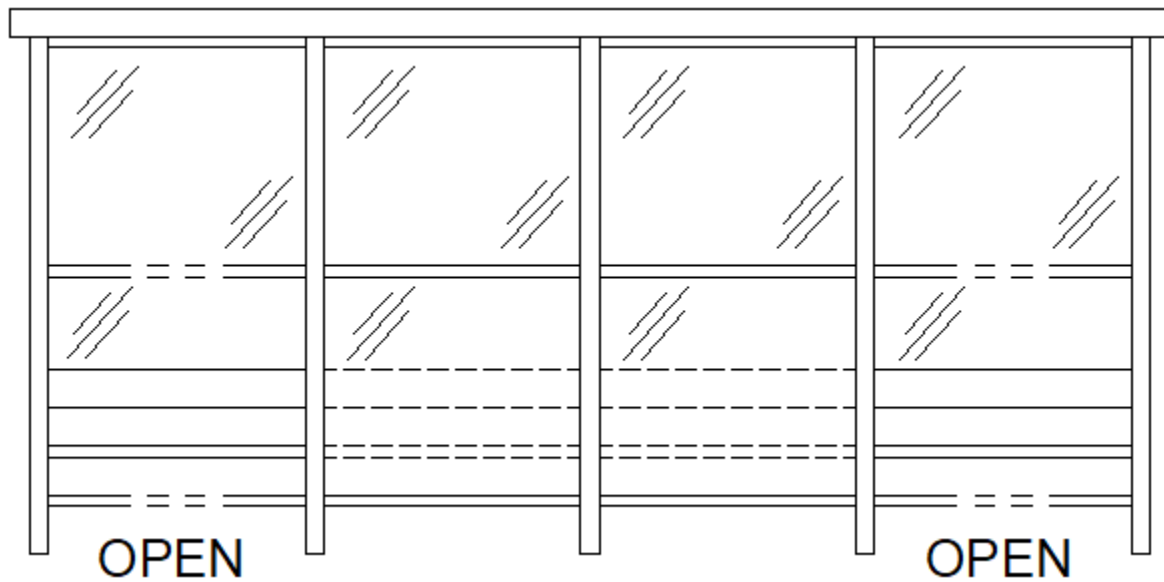

The Company tries to ensure that the shelter arrives to your location in excellent condition. If the product arrives damaged or parts are missing (or you need some installation assistance), please call Customer Service.

# **PARTS IDENTIFICATION**

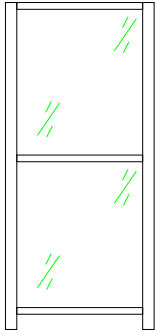

**TYPICAL WALL SECTION**

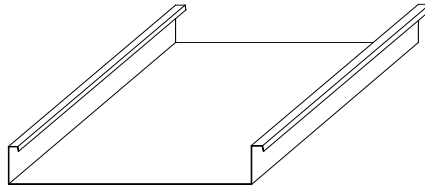

**ROOF DECK PAN**

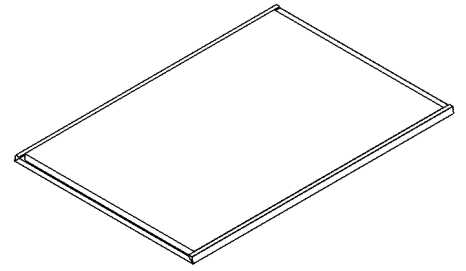

**CEILING PAN**



**HALF POST PER  
EXIT/ENTRANCE**

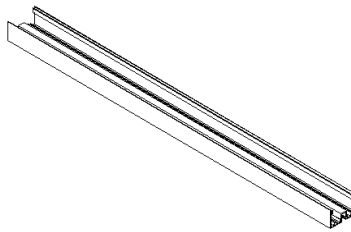

**MASTER FRAME PER  
EXIT/ENTRANCE**

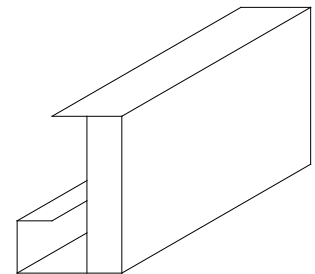

**FASCIA**

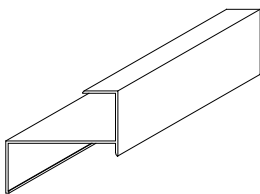

**RECEPTOR**

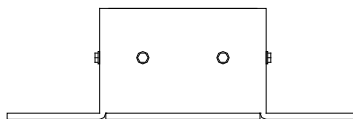

**ANCHOR SHOE**



**WEATHER SEAL TAPE**

## **ADDITIONAL ITEMS:**

- CAULK
- TOUCH UP PAINT

# **FASTENER IDENTIFICATION**

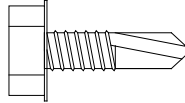

**#10 X 3/4" CLIMASEAL TEK SCREW**

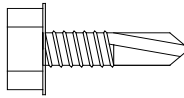

**#10 X 3/4" HEX HEAD SCREW (COLOR OF SHELTER)**

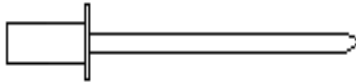

**3/16" POP RIVET (COLOR OF SHELTER)**

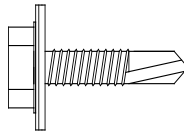

**#10 X 3/4" TEK SCREW W/NEOPRENE WASHER**

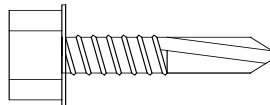

**#10 X 1" GALV HEX HEAD SCREW**

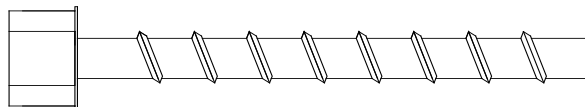

**1/4" X 1 7/8" SCREW ANCHOR**

## **ASSEMBLY TOOLS REQUIRED**

The tools that are needed for the assembly of our shelter would be the following:

- 1.) Rubber mallet
- 2.) Power screw gun with 1/4", 5/16" & 7/16" nut driver bits.
- 3.) Power drill with a 3/16" & 1/4" drill bit.
- 4.) Pop rivet gun.
- 5.) 25' tape measure.
- 6.) Steel claw hammer.
- 7.) Caulk gun (10.3 oz. tube size)
- 8.) Chalk line.
- 9.) Rotary hammer/masonry power drill with 1/4" masonry drill bit.
- 10.) Vise grips - C style with wide grip opening and end pads (clamp).

## **STEP 1** – Site Preparation

Shelter shall be installed on level flat concrete pad with changes in elevation not to exceed 1/2" over the length of the shelter. Layout the shelter out to out dimensions making sure the layout is square.

**CAUTION: AS YOU ASSEMBLE THE SEQUENTIALLY NUMBERED PANELS BE SURE THE PANELS CREATE THE SHELTER ASSEMBLY PATTERN SHOWN ON THE INSTALL LAYOUT ATTACHED.**

## **STEP 2** – Entrance/Exit Assembly

Screw master frame and half posts together using #10 x 1" screws. Note: half posts are pre-drilled. See **Figure 1** below.

**NOTE: HALF POSTS ARE PRE-DRILLED. ASSEMBLE PRIOR TO INSTALLING WALL SECTIONS.**

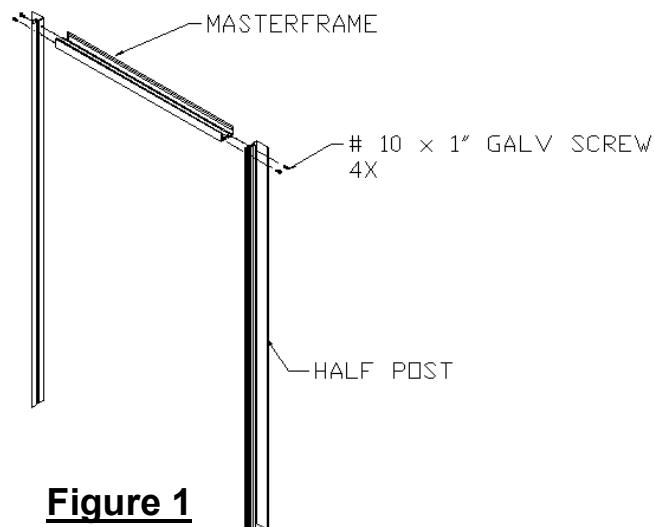

**Figure 1**

## **STEP 3** – Wall Section Install

Carefully unpack the wall sections from crate(s). Wall sections are numbered and correspond to the numbering sequence on the plan view of the install layout drawing. Start at #1 & #2 wall sections (corner connection). Snap the two wall sections together by lightly tapping with a rubber mallet starting at the top of the sections working down the mullion. Proceed with the remaining wall sections in the same manner, continuing with the next appropriate number.

**(SEE INSTALL LAYOUT ATTACHED)**

**Note: Be sure the opening for the entrance/exit is in the correct position or location per layout drawing**

**CAUTION: BE SURE THE SHELTER WALLS DO NOT FALL/TIP OVER DURING INSTALLATION.**

## **STEP 4** – Receptor Install

Make sure the wall sections are square then install receptors. Install the receptors on top of the wall sections. Attach the receptors to the interior side of shelter using #10 x 3/4" hex head tek screws every 12 inches on center. See **Receptor Layout** attached and **Figure 2** below.

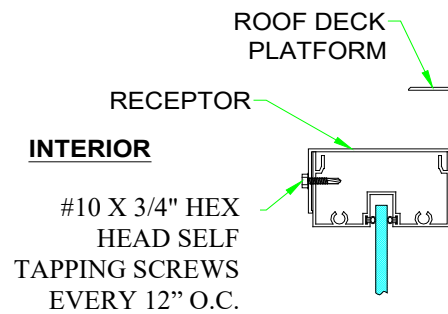
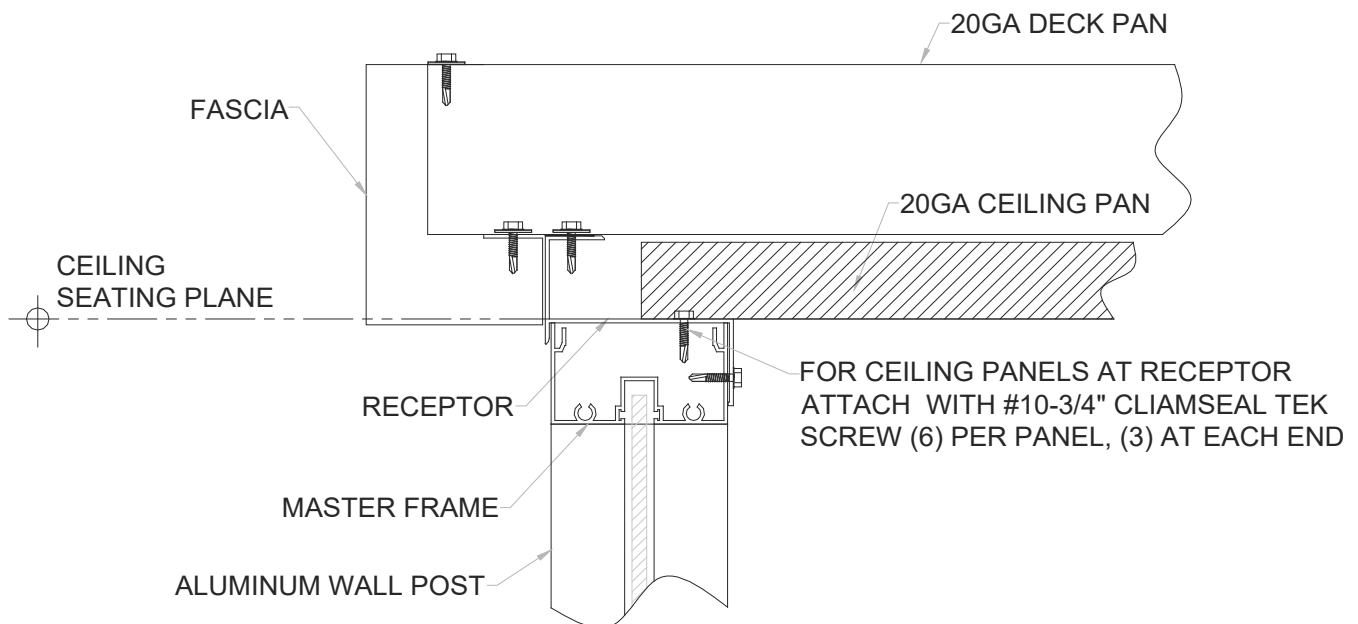

**Figure 2**

## **STEP 5** – Ceiling Panel Install

Strip the plastic protective film off the panels.

As you can see from Figure 2a, the ceiling panel is placed on top of the receptor with the white finish toward the interior of the shelter. Space the panels evenly across the shelter and attach them by using #10 x 3/4" climaseal tek screws with (6) per panel, (3) at each end. You will need to start with the first panel and attach before installing the remaining panels. Be sure to push the remaining panels tight to the previously installed panels to be sure that they will fit at the last end wall. Remember to strip off protective plastic on the interior side. See **Ceiling Layout** attached and **Figure 2a** below.



**FIGURE 2a: Installation of interior ceiling panels.**

## **STEP 6** – Deck pan Install

**Step A** - Strip off the protective plastic on the interior side of the roof. Place a strip of putty tape on the top of the receptor where it sits on the roof deck platform. The roof deck pans are designed to overlap into the gutter system (see attached **Roof Layout** for approximate overhang). The roof deck will be under the top most return of the fascia/gutter system on all sides. See **Roof Layout** attached and **Figure 3**.

**NOTE: ALL DECK PANS SHOULD BE IN PLACE BEFORE ATTACHING TO RECEPTOR.**

**Step B** - Attach deck pans to the receptor using (3) #10 x 3/4" tek screws with neoprene washers at each end of the deck pan where it meets the receptor and every 12 inches on center along Elevation B and D.

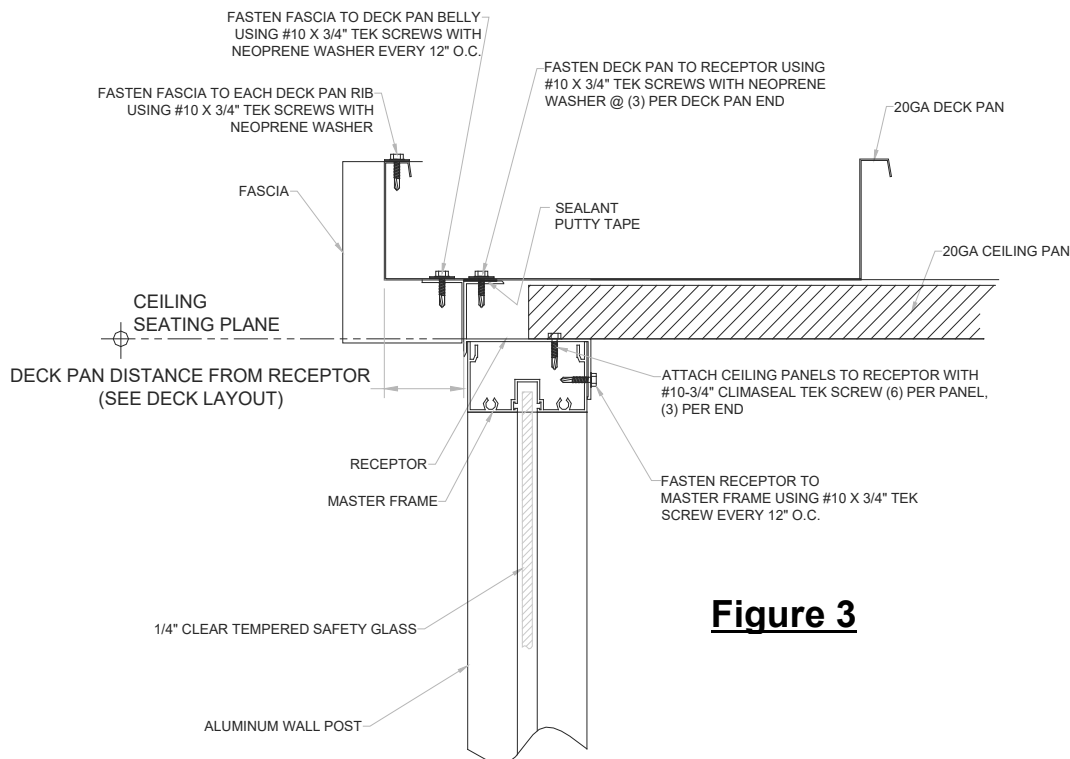

**Figure 3**

## **STEP 7** – Fascia Install

**Step A** - Strip off the protective plastic on the finished side of the fascia. The fascia/gutter system is placed against the receptor with the large opening of the gutter facing the exterior of the shelter. See **Fascia Layout attached**.

**Step B** - Start at a corner and align and support (2) pieces of the fascia/gutter system. Be sure that the outside face of the fascia is level before attaching to the deck pans. When attaching the corners of the fascia, be sure the outside faces are aligned with each other in both directions. Fasten the fascia/gutter to the top of the deck pan ribs and the deck pan belly using #10 x 3/4" tek screws with neoprene washers every 12" on center.

**Note:** The vertical returns on the fascia ends must be inside the mitered fascia corner. Drill 3/16" diameter holes through the face of the mitered fascia and the vertical return of the outside straight fascia section, 2 holes per corner. Caulk between inner and outer fascia overlap at corner thoroughly.

Fasten with 3/16" aluminum pop rivets, 2 per corner. Repeat this process for the remaining corners. See **Figure 4** below.

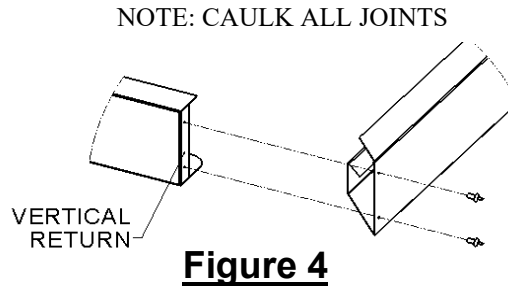

**Step C** – For middle section, telescope outside straight fascia with inside straight fascia. Be sure that the outside face of the fascia is level before attaching to the deck pans. Fasten the fascia/gutter to the top of the deck pan ribs and the deck pan belly using #10 x 3/4" tek screws with neoprene washers every 12" on center.

**Note:** Drill 3/16" diameter holes through the face of the telescoping fascia. Caulk between inner and outer fascia overlap thoroughly. Fasten with 3/16" aluminum pop rivets, 2 per telescoping fascia section. Repeat this process for other telescoping sections.

## **STEP 8** – Anchoring

Anchor the shelter to the concrete pad. See **Figure 5**.

Fit the anchoring shoes around the exterior of each of the posts. Although six holes are provided in anchor shoe, only 4 anchors per shoe are required. Mark the holes to be drilled in concrete pad using the anchor shoe as a template. Remove the anchor shoe and drill into the concrete pad. Be sure the holes are deep enough for the Screw Anchors to anchor shelter properly. See screw anchor install attached.

Fit the anchoring shoes around the exterior of each of the posts and attach the shoes to the posts with (6) #10 x 3/4" hex head self-tapping screws in the holes provided. Screw 1/4" x 1 7/8" Hilti screw anchors provided.

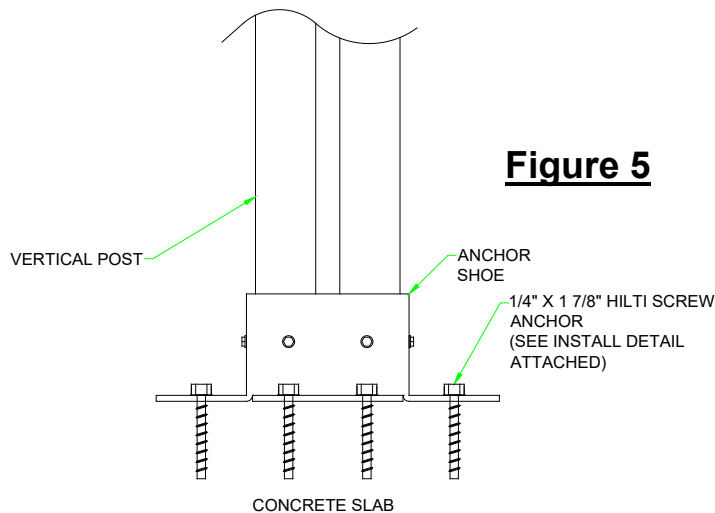

## **STEP 9**

With a 1-1/4" hole saw, drill a (four total), 1-1/4" diameter drain hole centered in fascia gutter 4" from each corner. For best results drill weep holes away from entranceway(s). Actual location may vary based on site location. SEE INSTALL LAYOUT FOR LOCATION

Call our Customer  
if you need clarification of these assembly instructions.

## **BENCH PARTS IDENTIFICATION**



**BACKREST – QTY: (SEE SHIP LIST)**

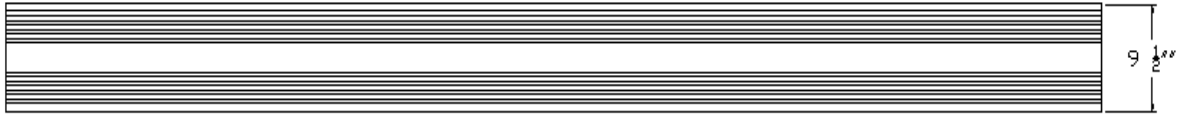

**BENCH – QTY: (SEE SHIP LIST)**



**BACKREST BRACKET – QTY: (6)**

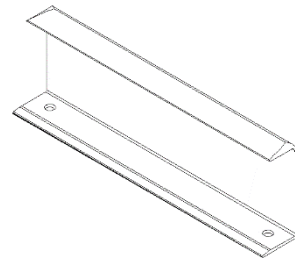

**END CAP – QTY: (8)**



**BENCH SUPPORT LH – QTY: (3)**

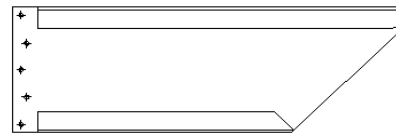

**BENCH SUPPORT RH – QTY: (3)**

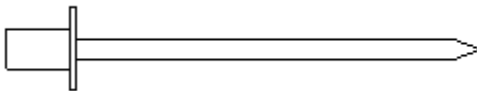

**3/16" ALUMINUM POP RIVETS**

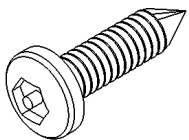

**1/4" X 1" STAINLESS STEEL SELF TAPPING SECURITY SCREWS**

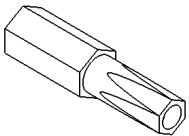

**#T27 6 LOBE SECURITY BIT**



## **STEP A.**

### **Installation of the bench.**

#### **DUE TO LENGTH, BENCH PLANK AND BACKREST SHIP IN TWO PIECES**

- A. Drill 3/16" diameter holes through 9 1/2" bench and 6" backrest using predrilled holes in end cap as guide, 2 per end cap. **See Figure 1**
- B. Secure end caps to bench and back rest with 3/16" pop rivets. (2 per end Cap)

NOTE: 4 caps are provided for both planks; cap all ends.

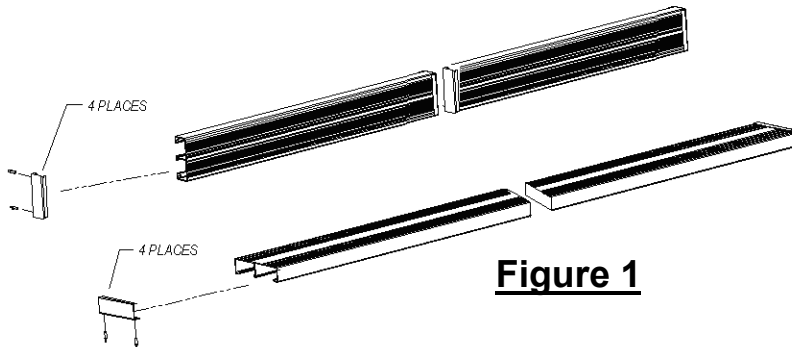

**Figure 1**

Locate bench supports on posts. **See Figure 2.** Note orientation of support at corner. **See Figure 2, Detail A.** Supports must be level, one to another. Using #T27 6 lobe security driver bit provided, secure bench supports to posts with 1/4" stainless steel self-tapping security screws, 5 per bench support. Note that at the center post where two-piece planks meet two bench supports will be provided to support either side of the bench seam.

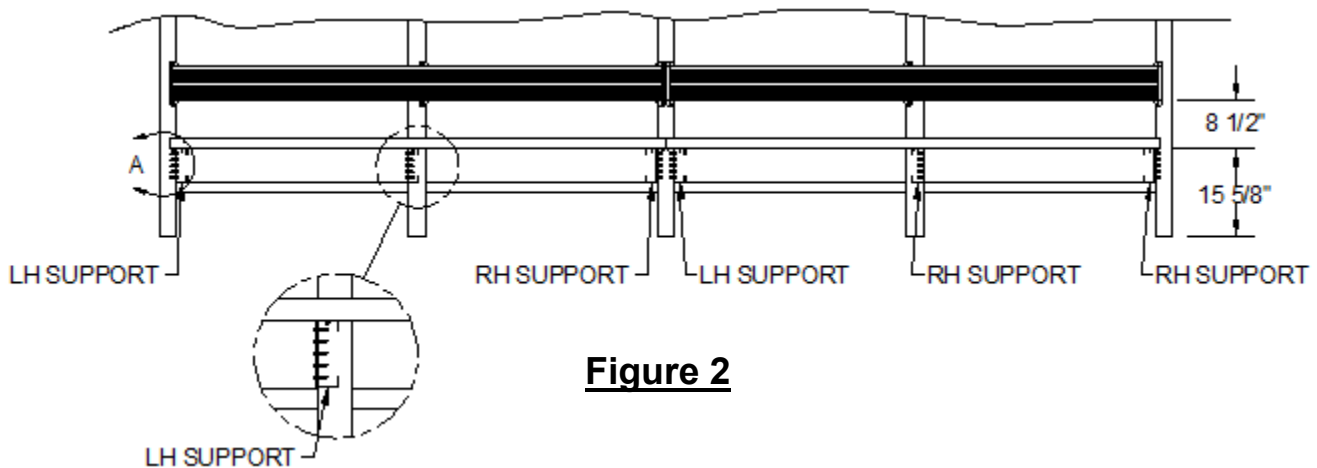

**Figure 2**

**Figure 2 – Detail A**

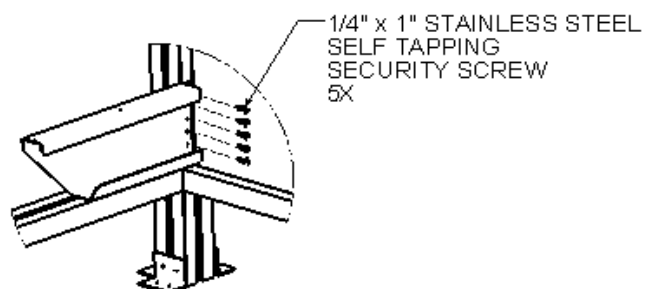

## Installation of the bench (cont.)

### STEP B.

Place the 9 ½" bench planks on top of the supports. Clamp in place. **See Figure 3.** Drill 3/16" diameter holes through the benches using the predrilled holes in the bench support as a guide, 2 per bench support. **Caution: drill holes through underside flange only.** Secure the benches to the supports with 3/16" diameter pop rivets, 2 per bench support. Remove clamps.

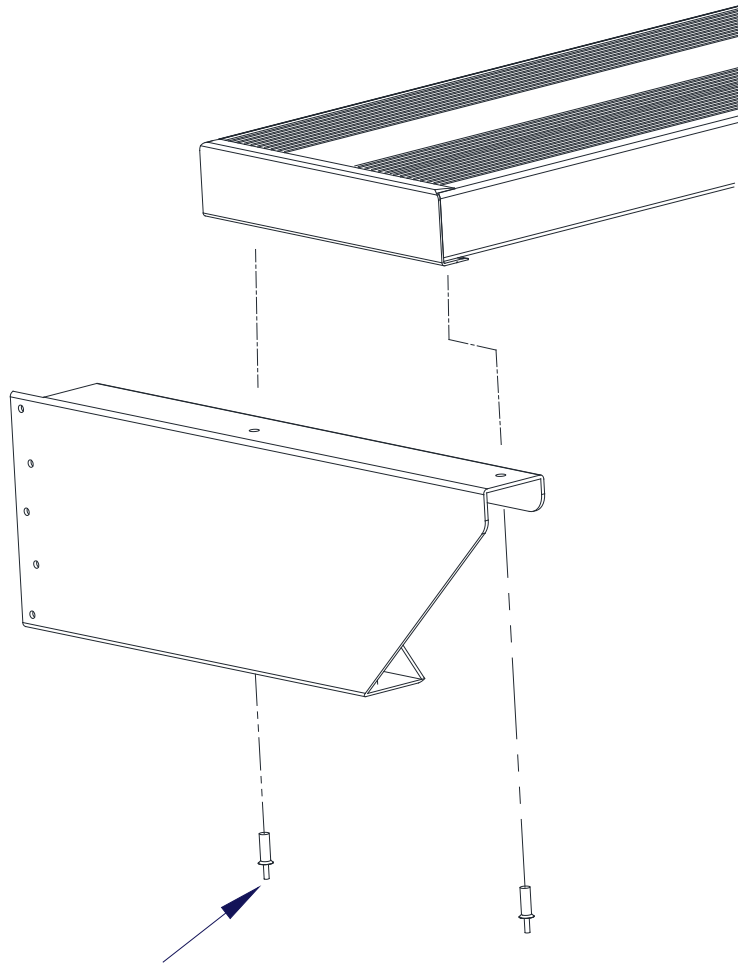

RIVET  
2X

**Figure 3**

## Installation of the bench (cont.)

### STEP C.

Lay backrest on its face and layout backrest bracket locations on backrest spaced as shown below to allow attachment to posts. Clamp in place. Drill 3/16" diameter holes through backrest using predrilled holes in backrest bracket as guide, 2 per backrest bracket. **Caution: drill holes through the rear flange of backrest only.**

**See Figure 4.** Secure backrest bracket to backrest with 3/16" pop rivets, 2 per backrest bracket. Remove clamps.

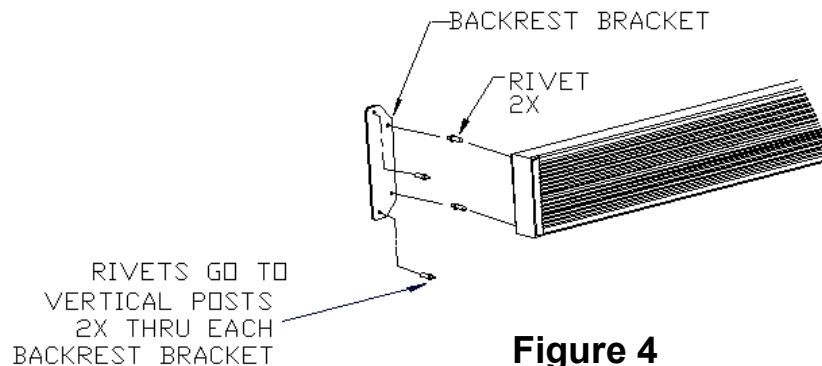
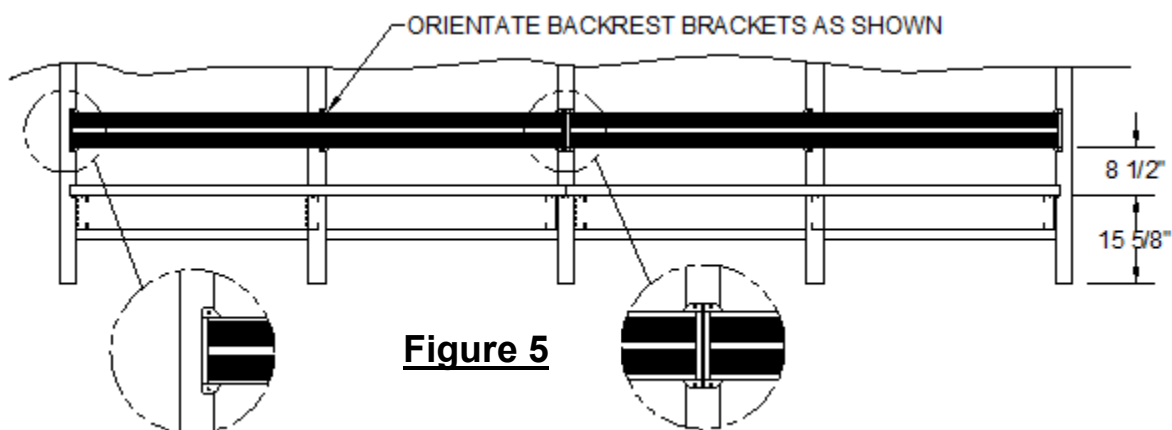

**Figure 4**

### STEP D.

Locate backrest on posts. Backrest must be level. **See Figure 5.** Drill 3/16" diameter holes through posts using predrilled holes in backrest bracket as a guide, 2 per post. Secure backrest brackets to posts with 3/16" pop rivets, 2 per post.

NOTE: Two Backrest Brackets have been provided to support backrest seam. Place both at center post of shelter facing opposite directions.



**Figure 5**

Call our Customer Service  
if you need clarification of these assembly instructions.