

35 Gal. Stone Aggregate Receptacle with Flat Lid Specifications

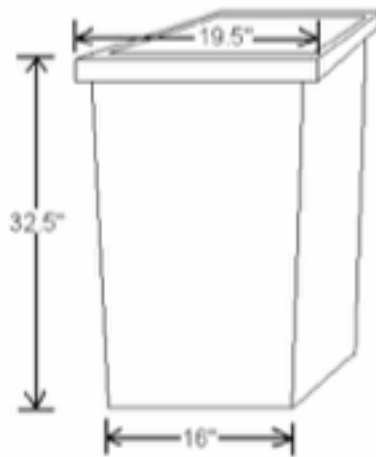

Specifications:

- Dimensions: 19.5" x 19.5" at top, 16" x 16" at base, 32.5" height
- Weight: 155 lbs
- Materials: Non-removable fiberglass liner, natural 3/8" river stone aggregate

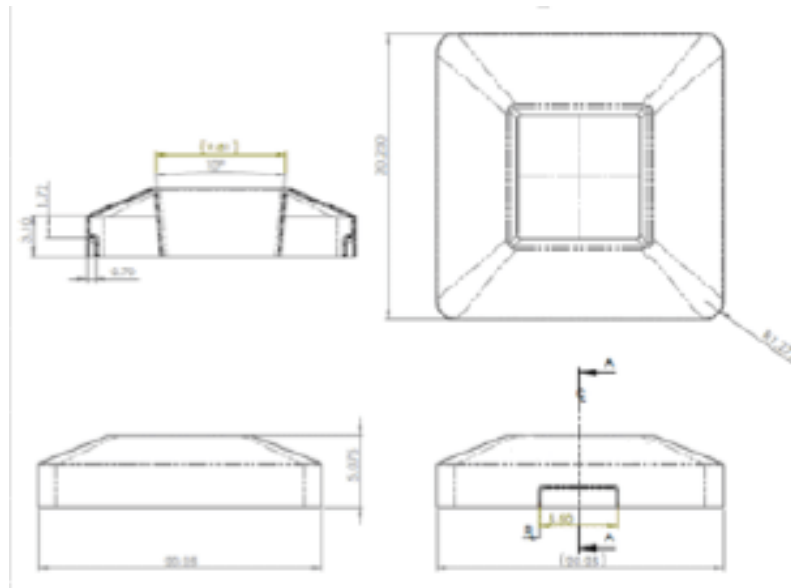

Specifications:

- Dimensions: 20-1/4" sq x 5" tall, .187" wall thickness, 10" sq opening for trash deposit
- Weight: 4lbs
- Materials: Rotationally molded #4 recyclable LDPE