

# **6' BENCH ASSEMBLY INSTRUCTIONS**

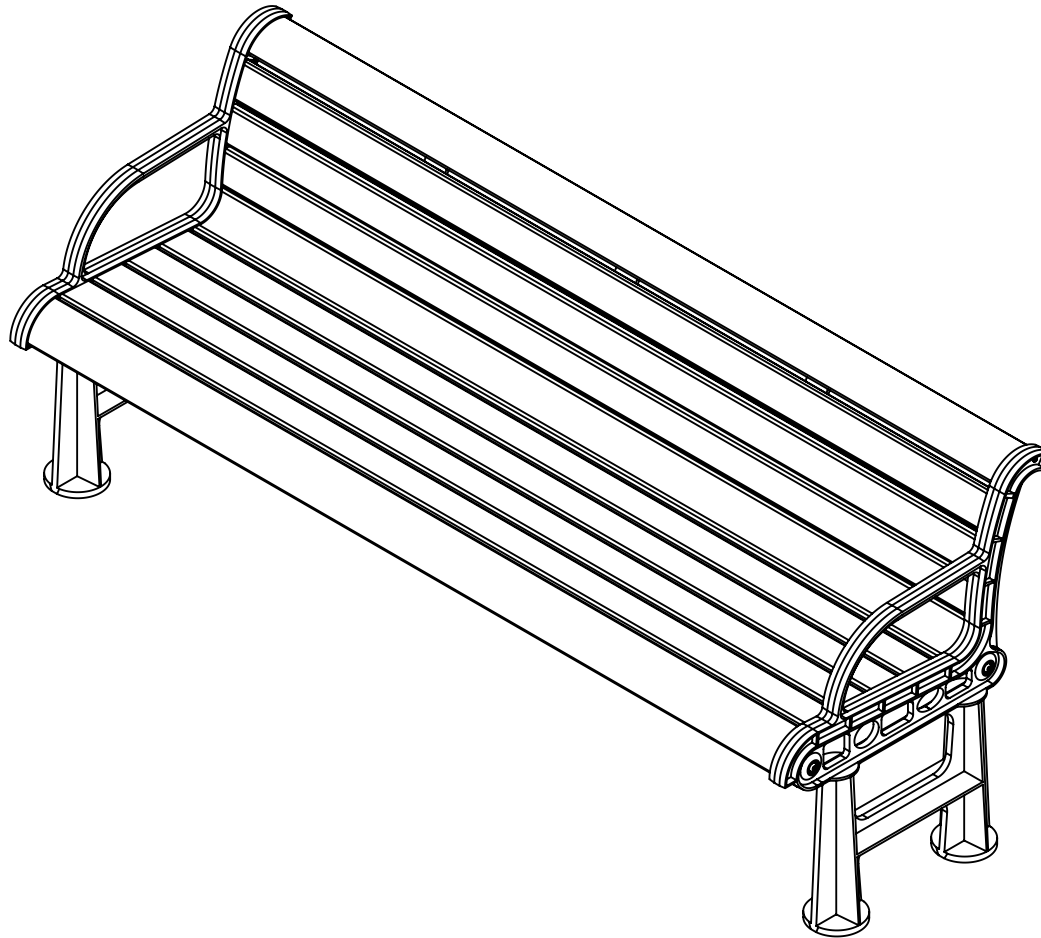

# 6' BENCH ASSEMBLY INSTRUCTIONS

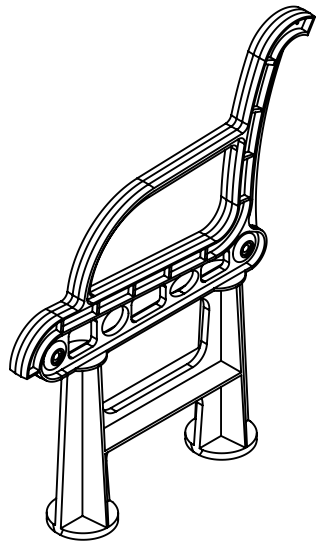

BENCH END  
2X

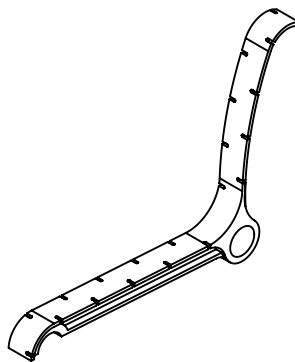

SEAT SUPPORT  
3X

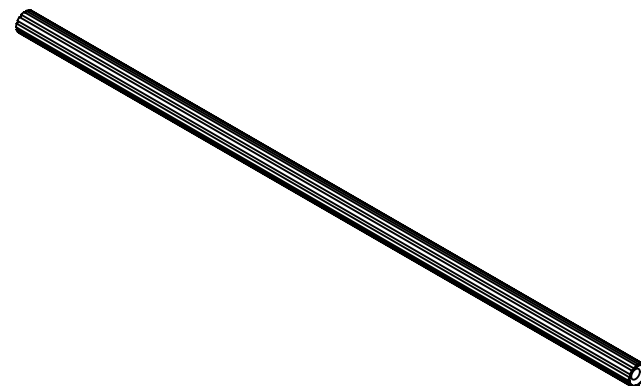

PIPE SUPPORT  
2X

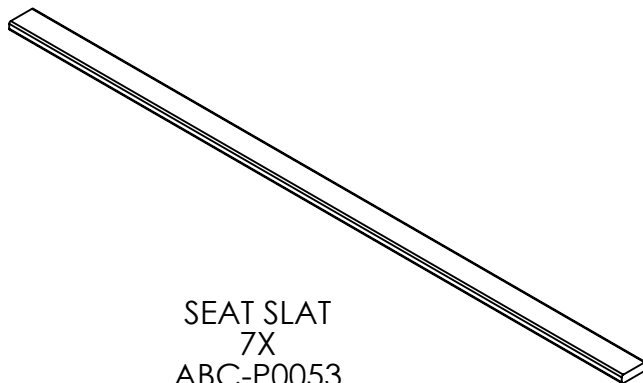

SEAT SLAT  
7X  
ABC-P0053

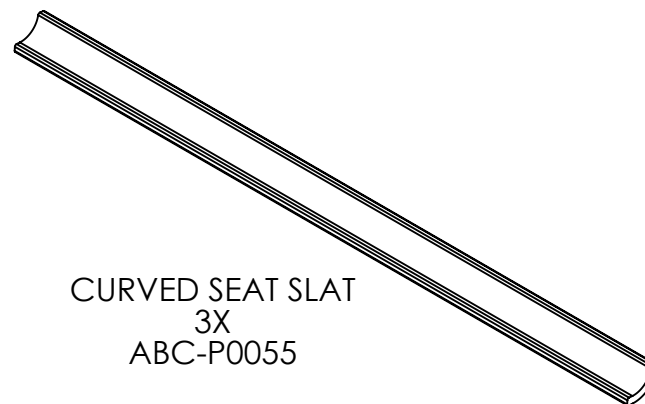

CURVED SEAT SLAT  
3X  
ABC-P0055

**COMPONENTS  
REQUIRED FOR  
ASSEMBLY**

**1/15**

## 6' BENCH ASSEMBLY INSTRUCTIONS

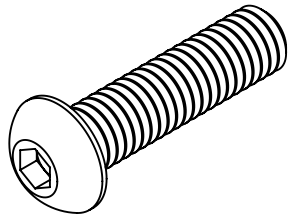

3/8-16 X 1.5"  
SOCKET BUTTON CAP SCREW  
4X  
F0001

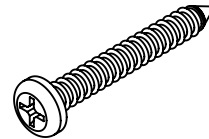

#10-1.25" PAN HEAD SCREW  
2X  
F0002

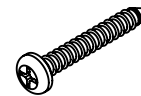

#10-.75" PAN HEAD SCREW  
60X  
F0003

### REQUIRED TOOLS:

- SCREW GUN
- PHILIP DRIVE BIT
- 9mm ALLEN WRENCH
- A FRIEND TO HELP

**HARDWARE &  
TOOLS REQUIRED  
FOR ASSEMBLY**

**2/15**

## 6' BENCH ASSEMBLY INSTRUCTIONS

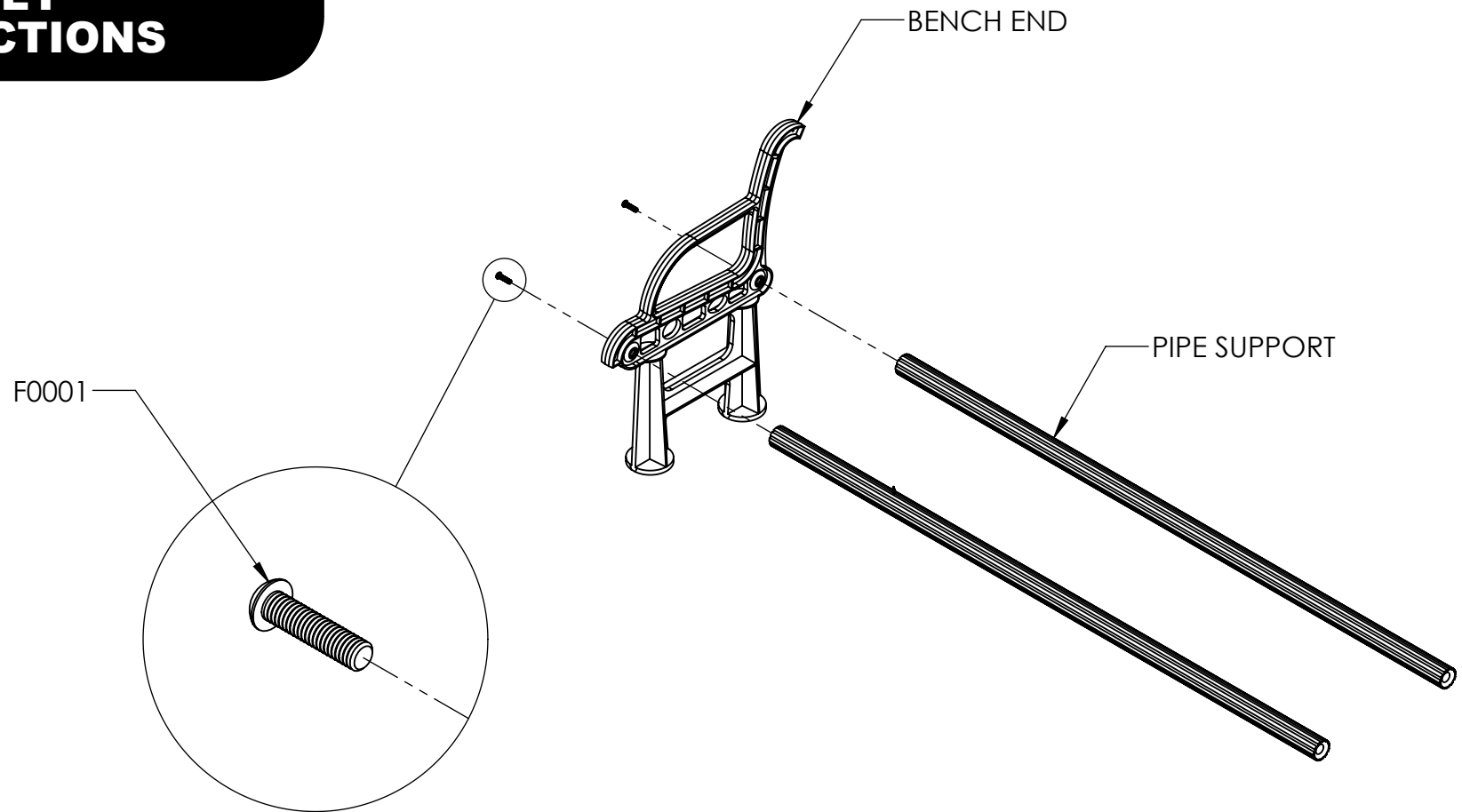

**NOTE: LOOSELY TIGHTEN HARDWARE**

# 6' BENCH ASSEMBLY INSTRUCTIONS

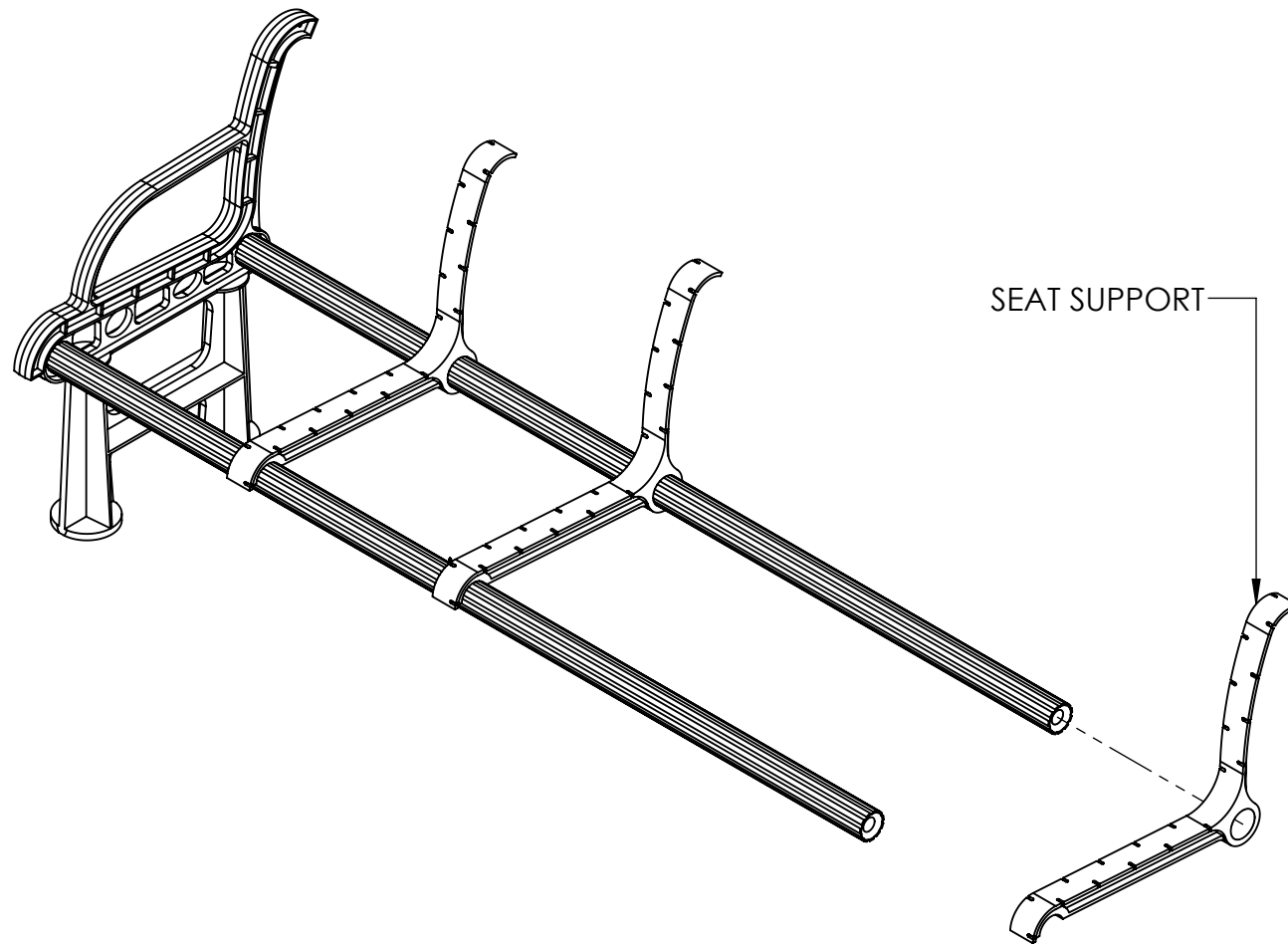

## 6' BENCH ASSEMBLY INSTRUCTIONS

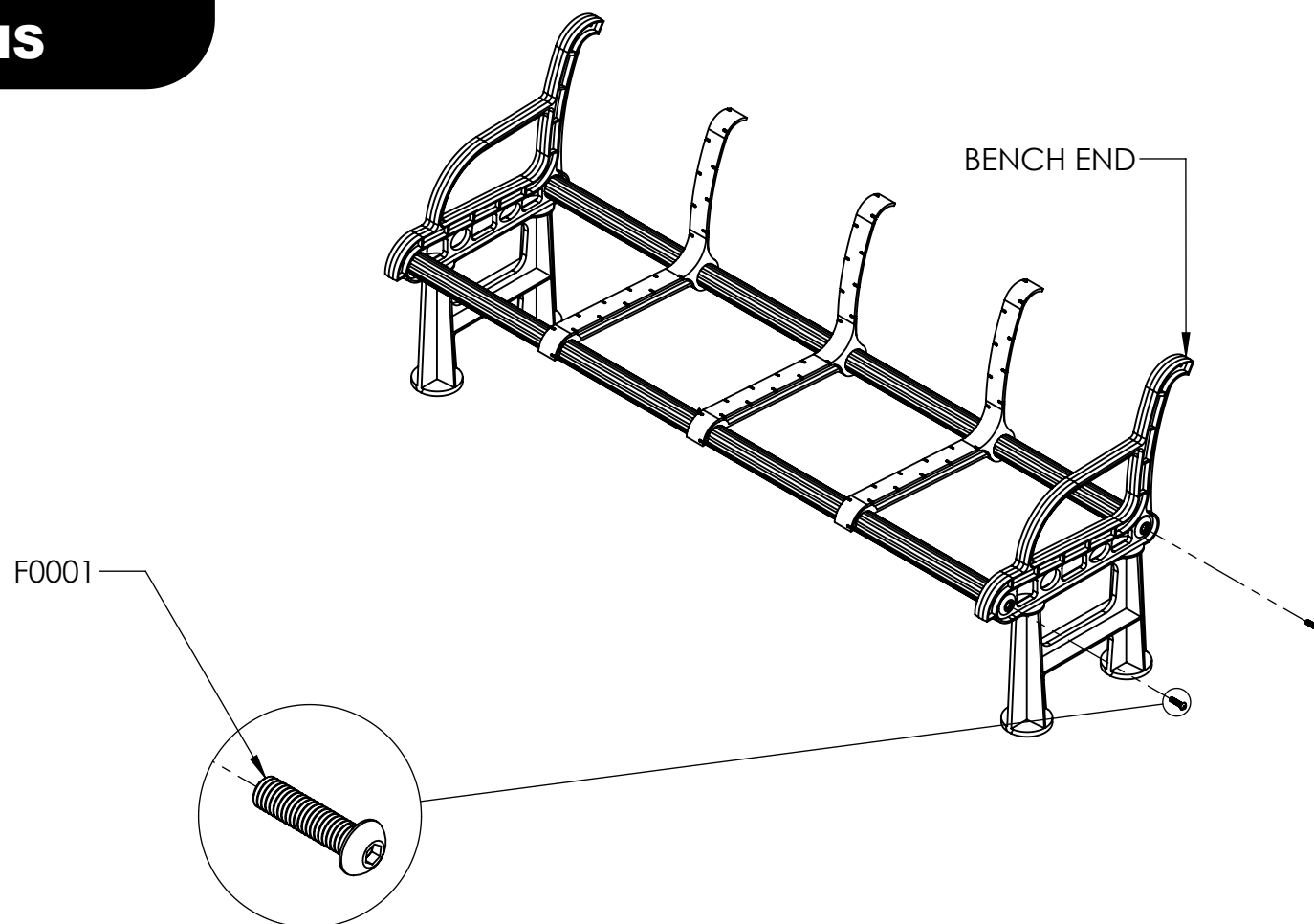

**NOTE: LOOSELY TIGHTEN HARDWARE**

## 6' BENCH ASSEMBLY INSTRUCTIONS

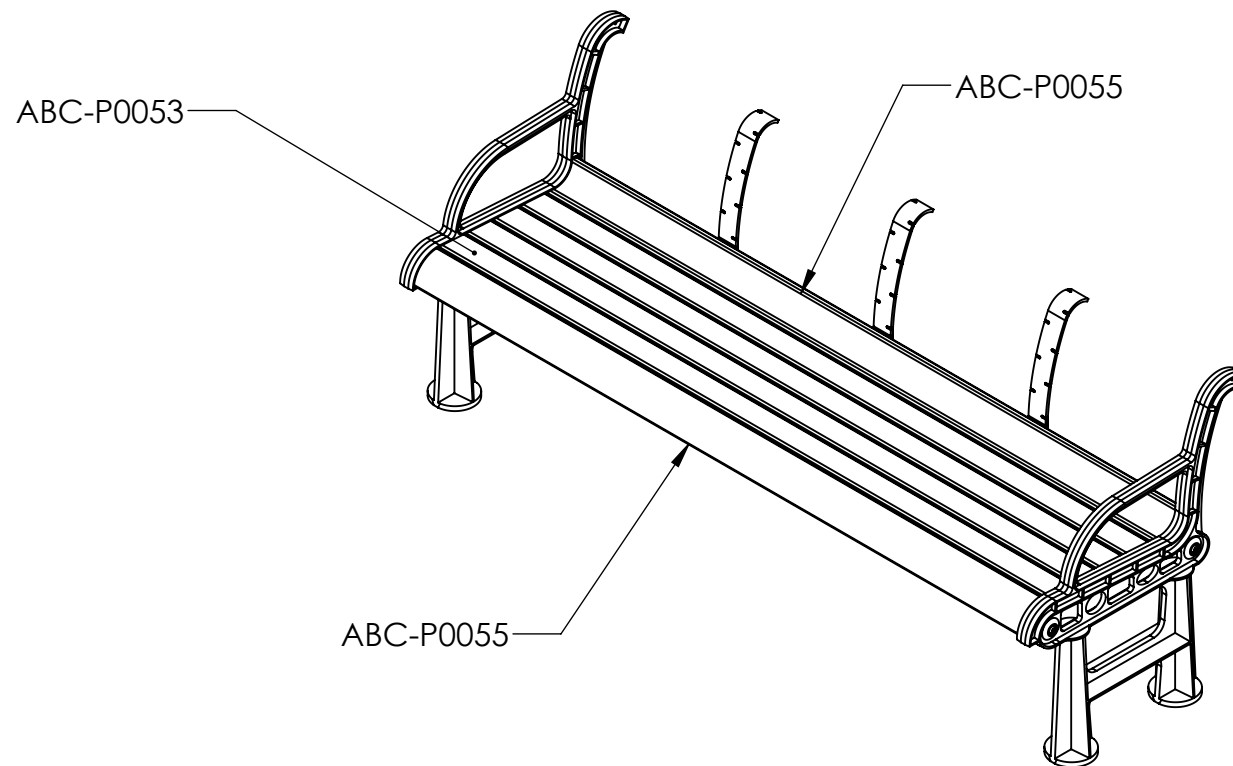

## 6' BENCH ASSEMBLY INSTRUCTIONS

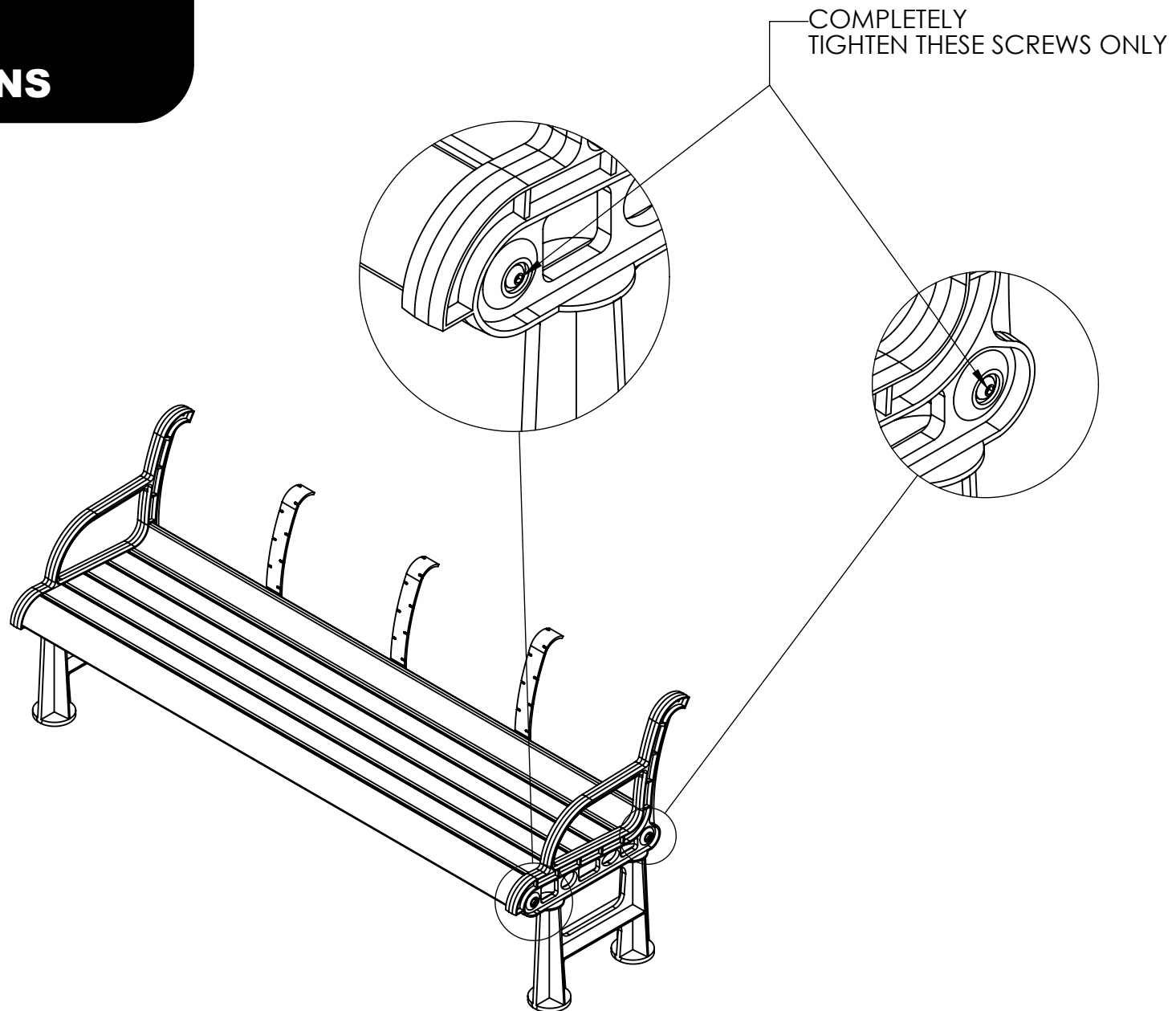

**TIGHTEN  
SCREWS**

**7/15**



## 6' BENCH ASSEMBLY INSTRUCTIONS

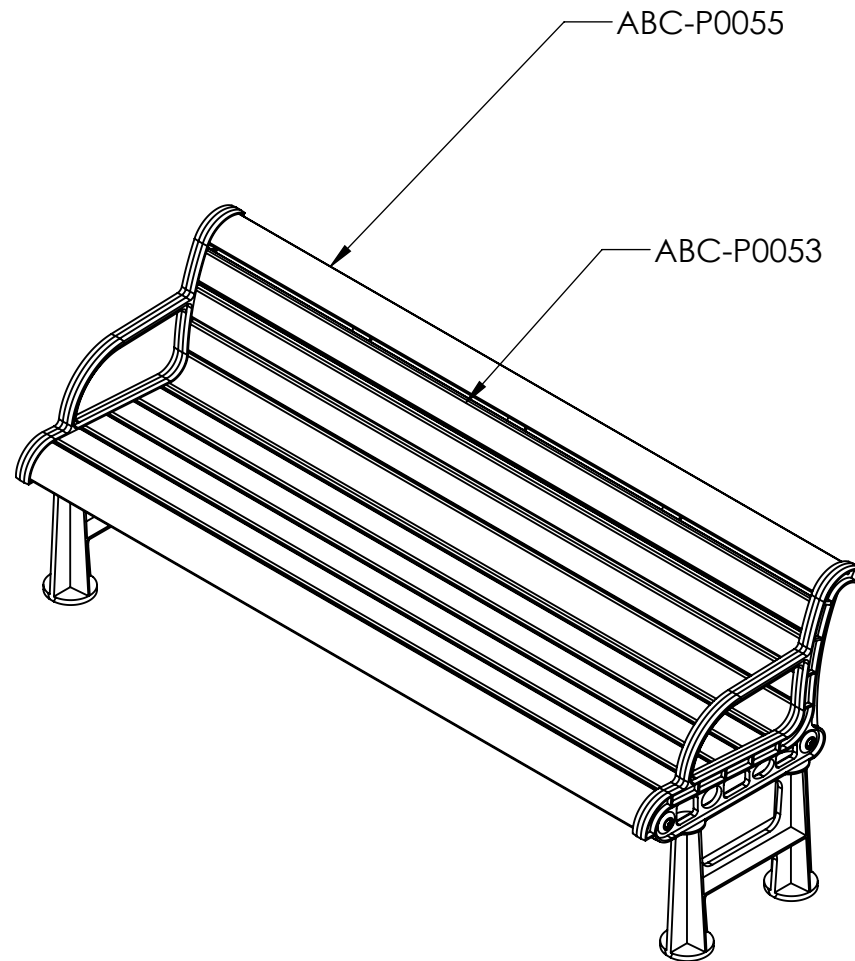

**INSERT BACK  
SLATS**

**8/15**

## 6' BENCH ASSEMBLY INSTRUCTIONS

COMPLETELY TIGHTEN  
THESE SCREWS

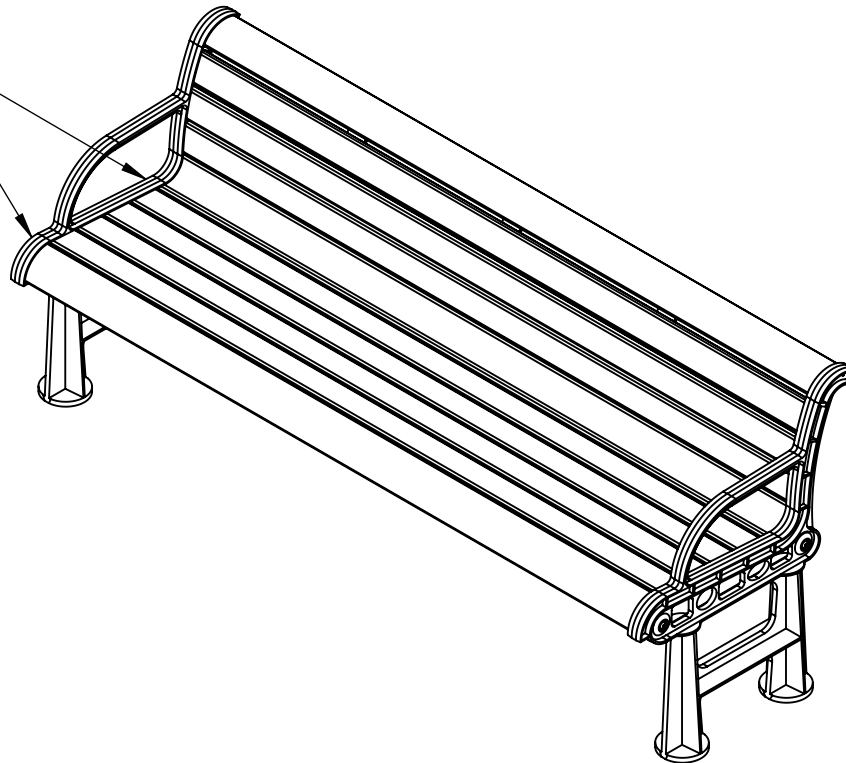

**TIGHTEN  
SCREWS**

**9/15**

# 6' BENCH ASSEMBLY INSTRUCTIONS

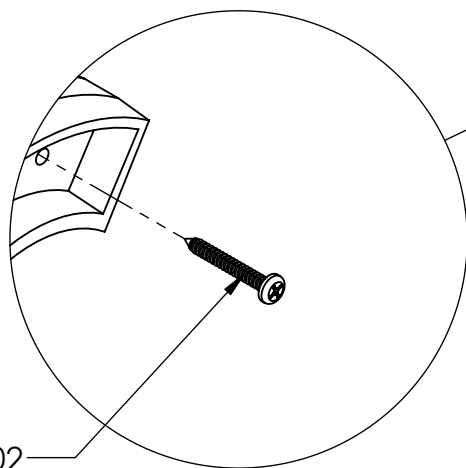
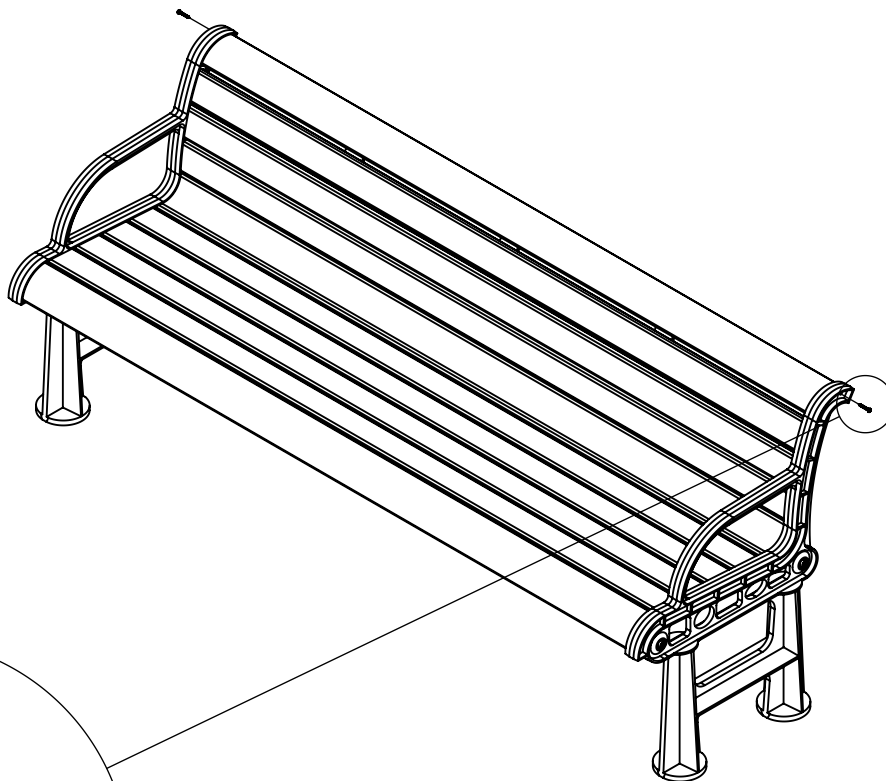

F0002

**FASTEN  
BACK SLAT**

**10/15**

## 6' BENCH ASSEMBLY INSTRUCTIONS

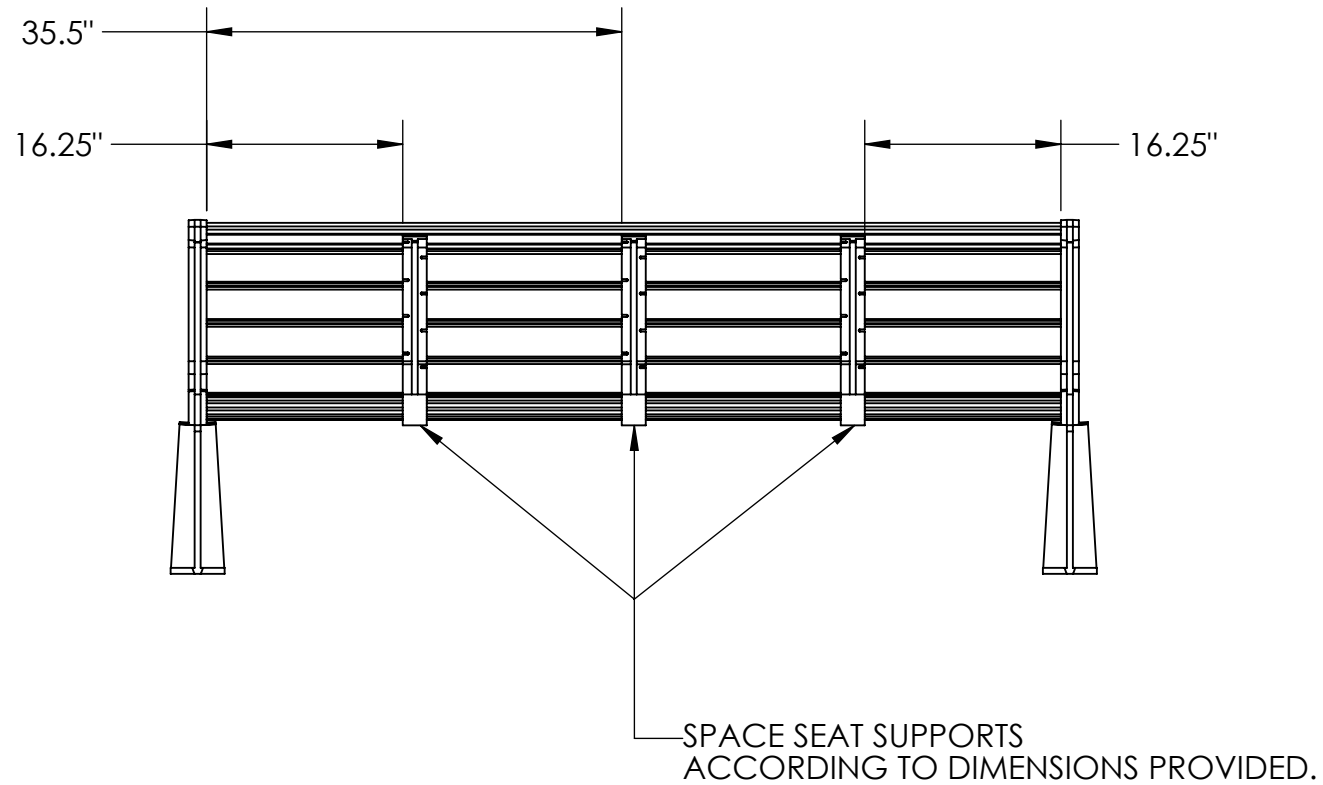

**(BACK VIEW)**

## 6' BENCH ASSEMBLY INSTRUCTIONS

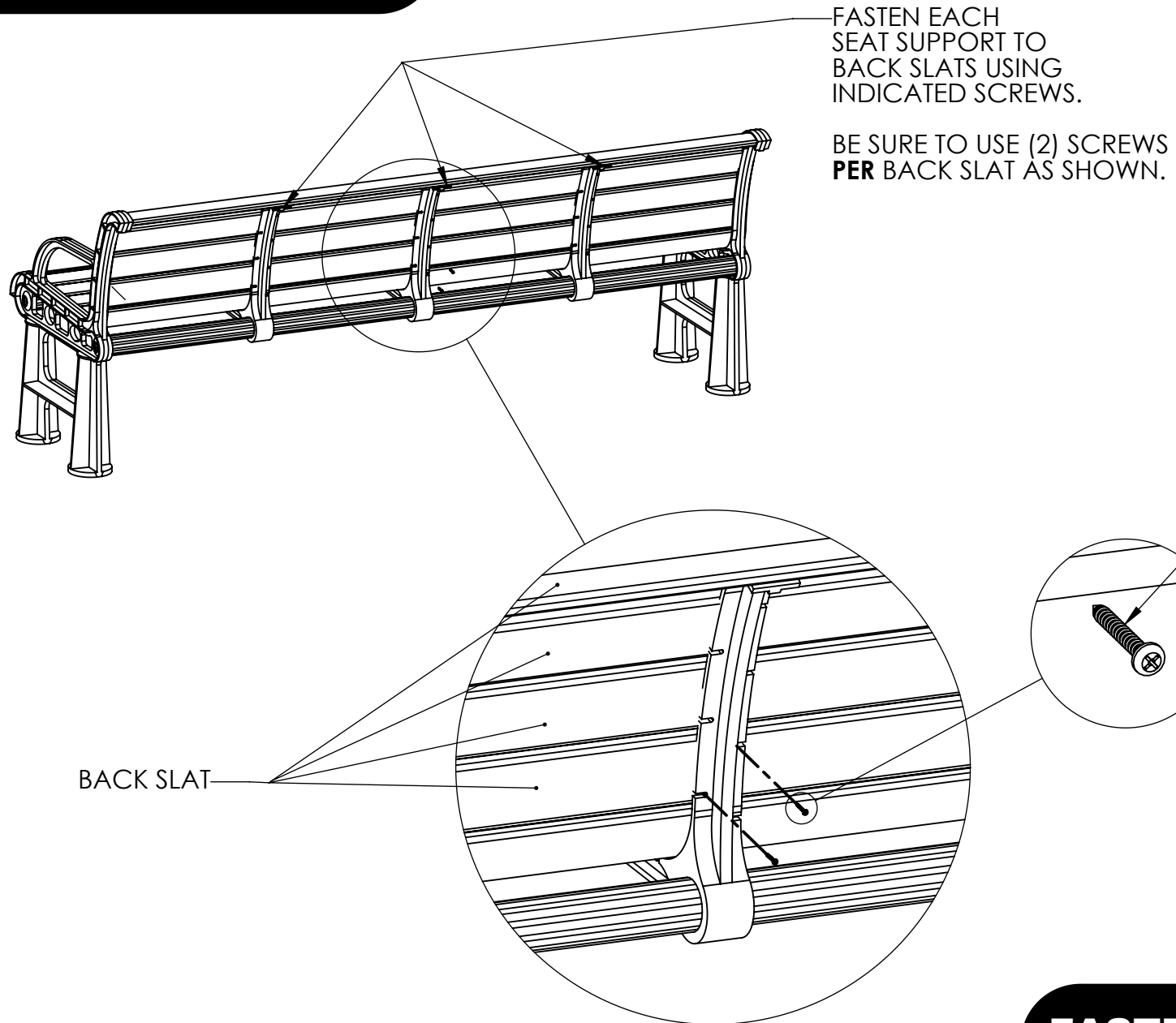

**FASTEN SEAT  
SUPPORTS**

**12/15**

## 6' BENCH ASSEMBLY INSTRUCTIONS

FASTEN EACH SEAT  
SUPPORT  
TO SEAT SLATS USING  
INDICATED SCREWS.

BE SURE TO USE (2)  
SCREWS PER SLAT  
AS SHOWN

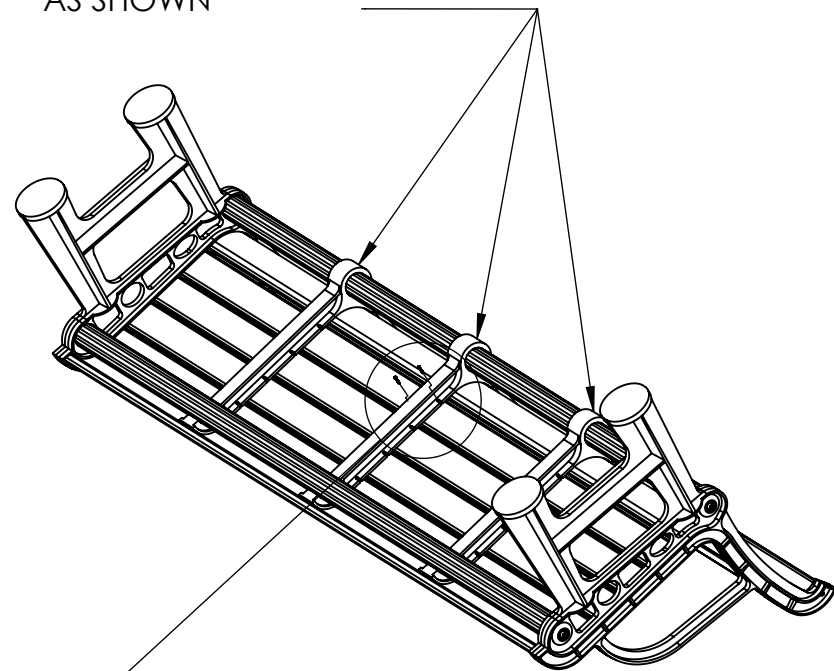
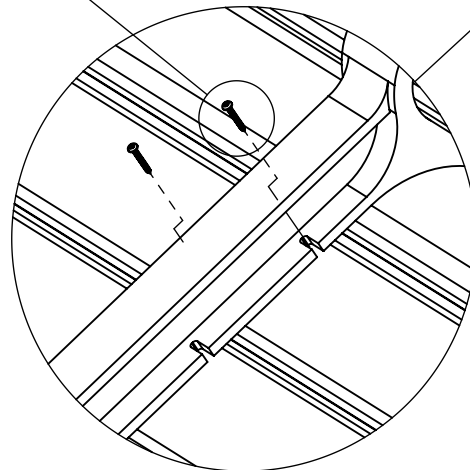
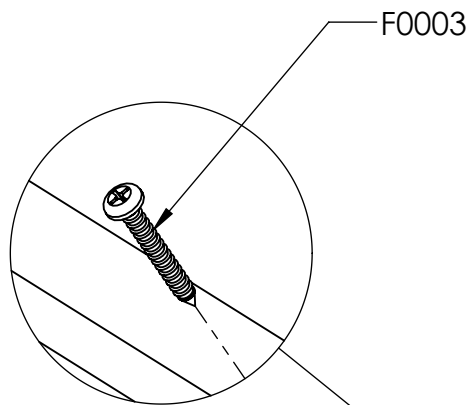

**FASTEN SEAT  
SUPPORTS**

**13/15**

## 6' BENCH ASSEMBLY INSTRUCTIONS

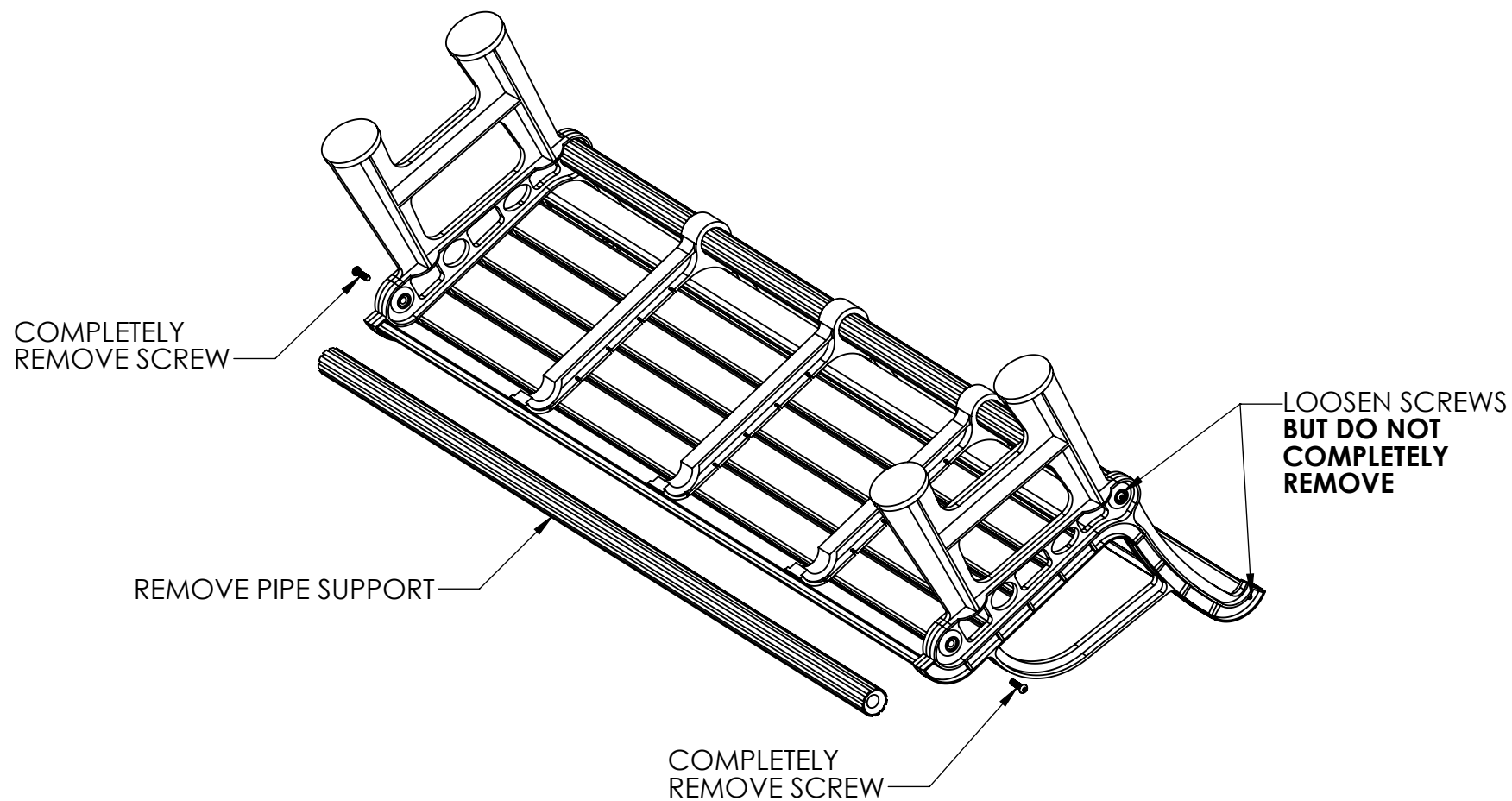

## 6' BENCH ASSEMBLY INSTRUCTIONS

FASTEN EACH SEAT SUPPORT  
TO FRONT SEAT SLATS USING  
INDICATED SCREWS.

BE SURE TO USE (2) SCREWS  
PER SLAT AS SHOWN

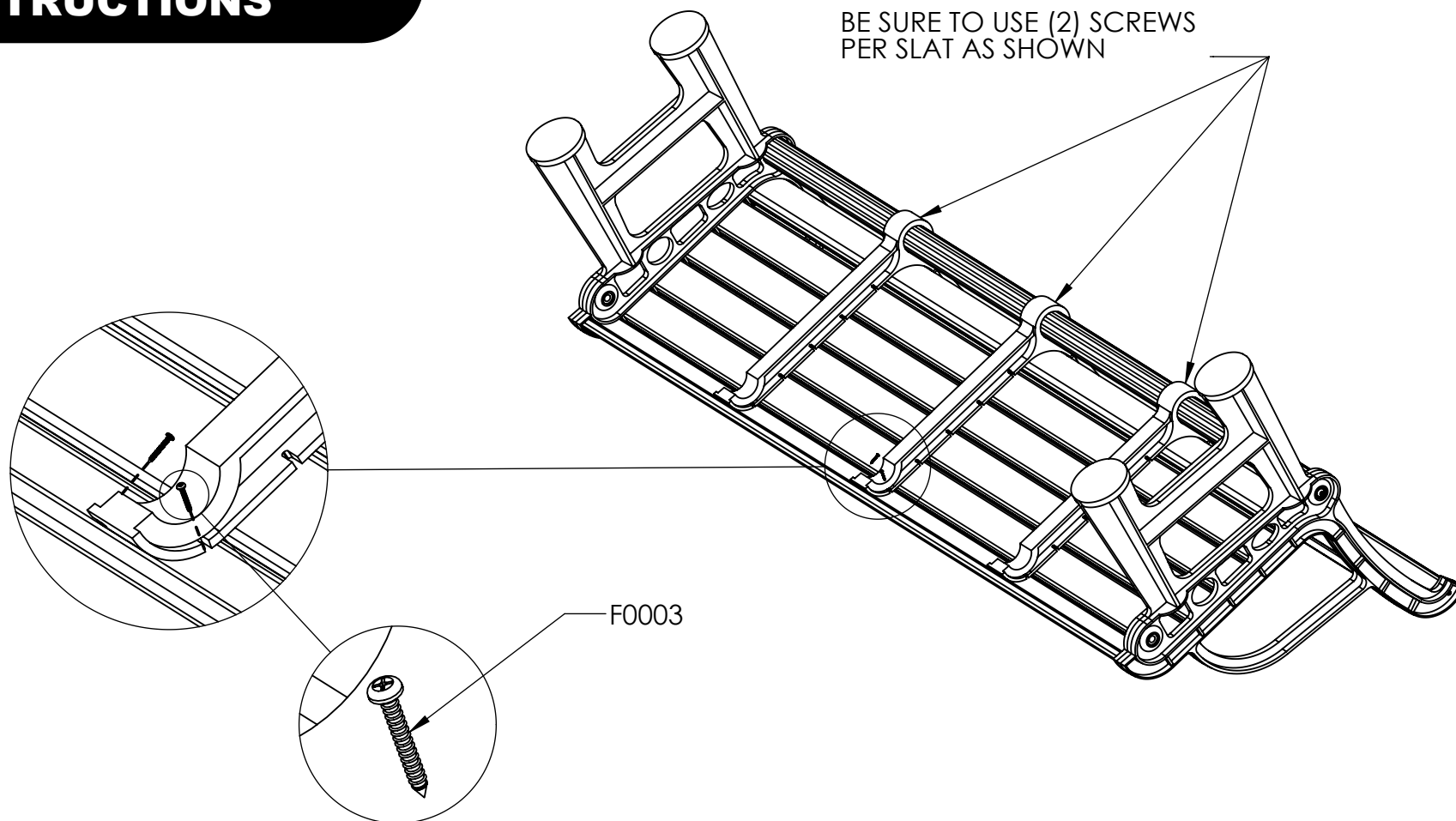

WHEN FINISHED FASTENING SEAT SUPPORT,  
REATTACH FRONT PIPE AND RETIGHTEN  
ALL HARDWARE

**FASTEN SEAT  
SUPPORTS**

**15/15**