

# BENCH INSTRUCTIONS

## BC1635

REV# 1

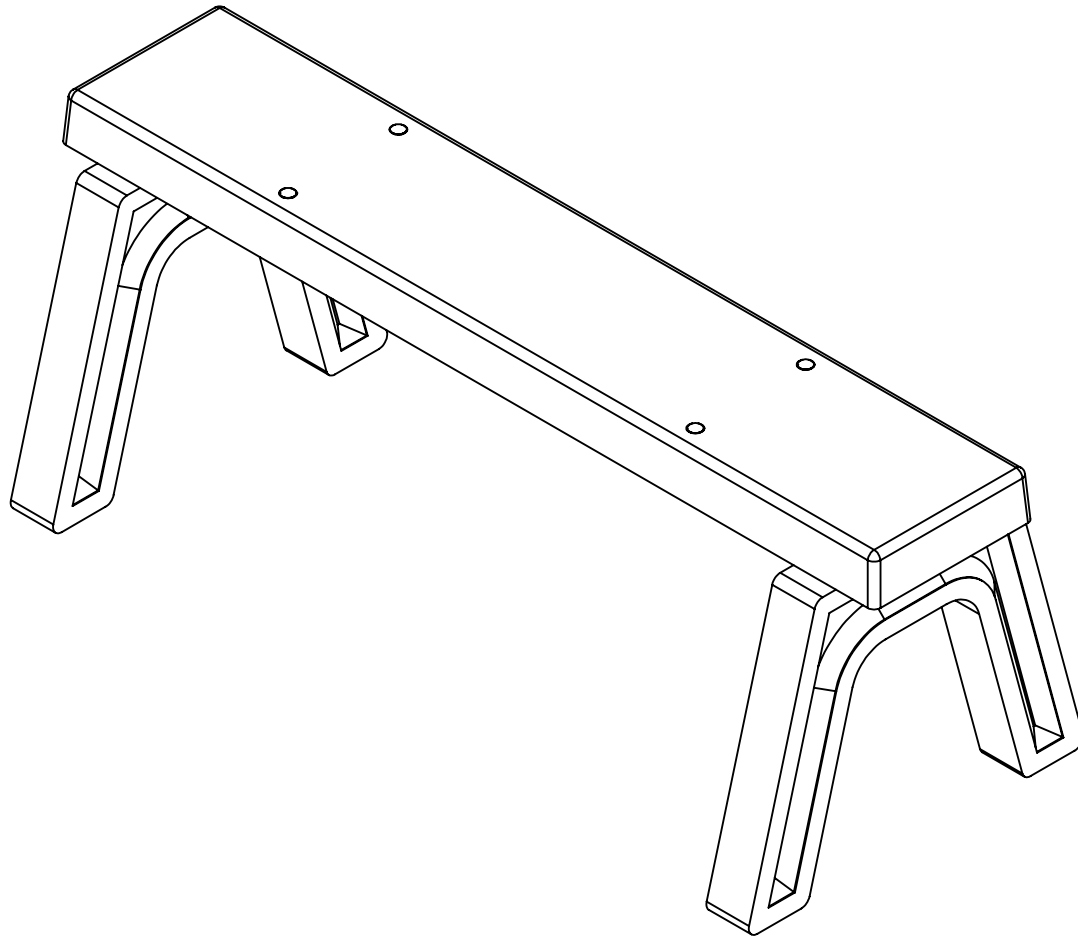

# BENCH INSTRUCTIONS

## BC1635

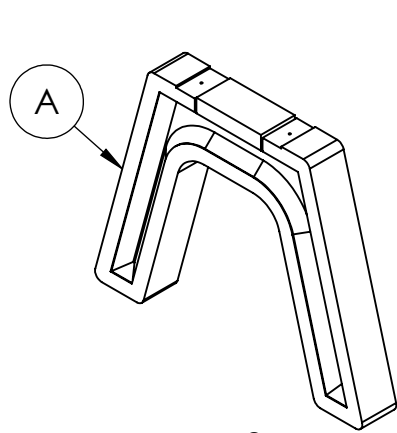

2  
Bench ends  
ABC-PPL1015

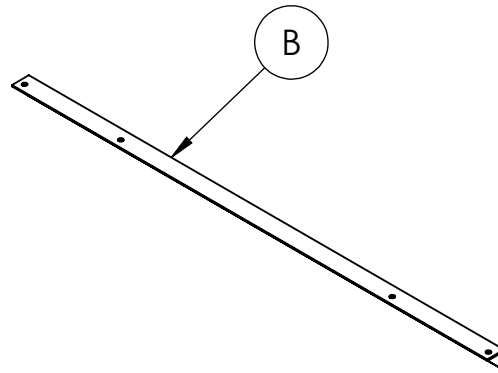

2  
Support brace

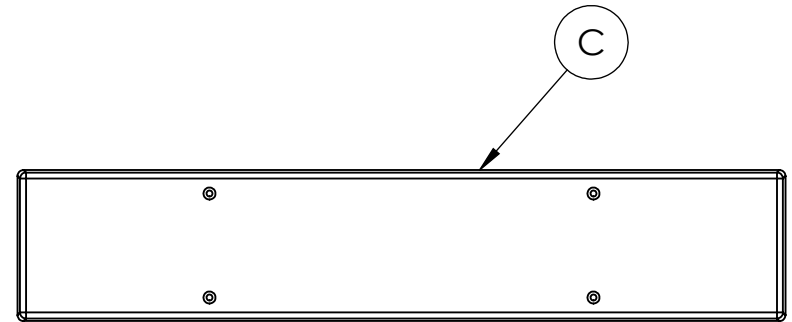

1  
Plastic boards

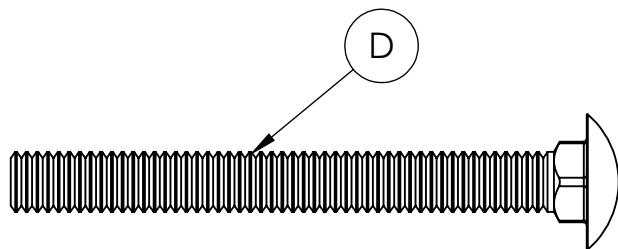

4  
3" x 5/16" Carriage bolt

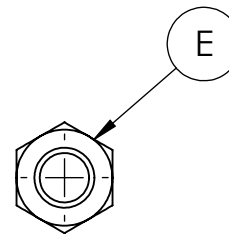

8  
5/16" Hex nut

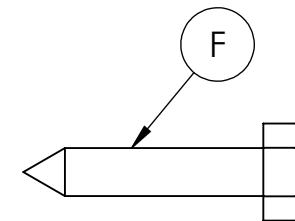

4  
1-1/4" x 1/4" Lag screw

### REQUIRED TOOLS (NOT INCLUDED)

- 1 - 1/2" SOCKET
- 1 - 7/16" SOCKET
- 1 - POWER DRILL

**NOTE: IT IS IMPORTANT TO KEEP ALL BOLTS FINGER TIGHT DURING ASSEMBLY UNTIL ENTIRE TABLE IS ASSEMBLED**

**HARDWARE &  
TOOLS REQUIRED  
FOR ASSEMBLY**

**2/4**

# BENCH INSTRUCTIONS

## BC1635

### STEP 1

- Stand both plastic bench ends (A) upright
- Place the support braces (B) into the plastic bench ends (A) as shown
- Make sure to align the holes of the support braces with the predrilled holes in the plastic bench end
- Use (4) 1-1/2" x 1/4" lag screws (F) to fasten the support braces (B) to the plastic bench ends (A)

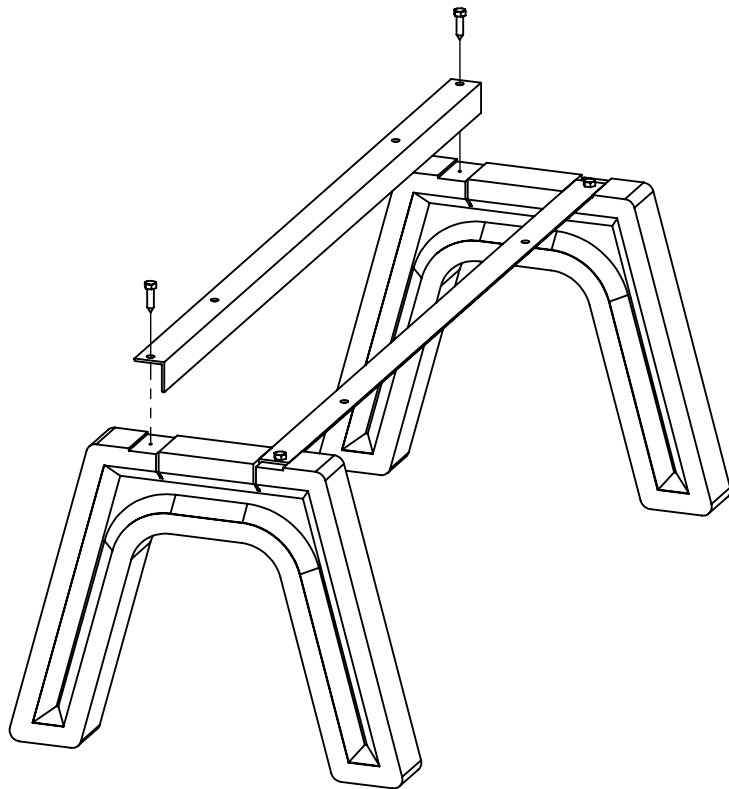

### Step 2

- Place a plastic board (C) over the plastic end supports (A)
- Align the holes of the plastic board (C) with the holes in the support braces (B)
- Secure with (4) 3" x 5/16" carriage bolts (D) and (4) 5/16" hex nuts (E)

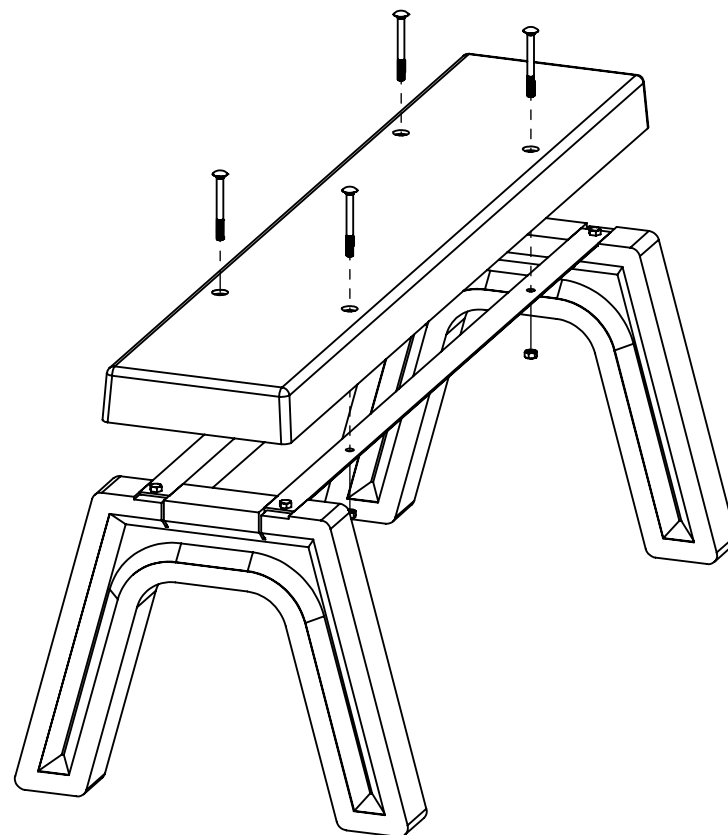

# BENCH SPECIFICATIONS BC1635

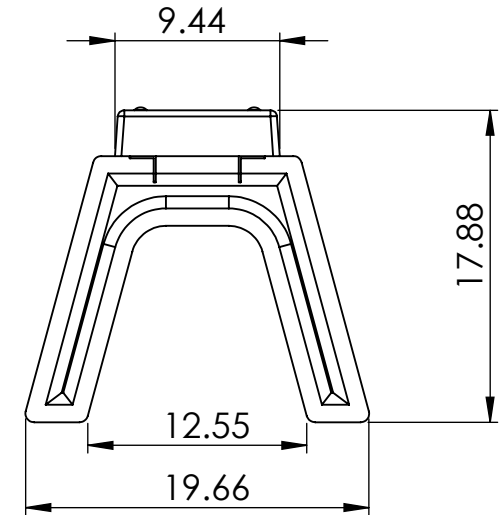
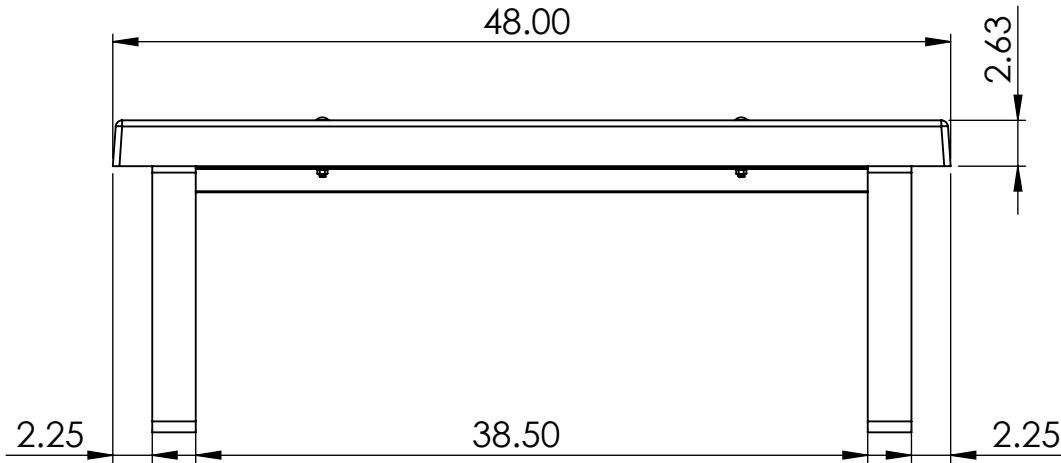
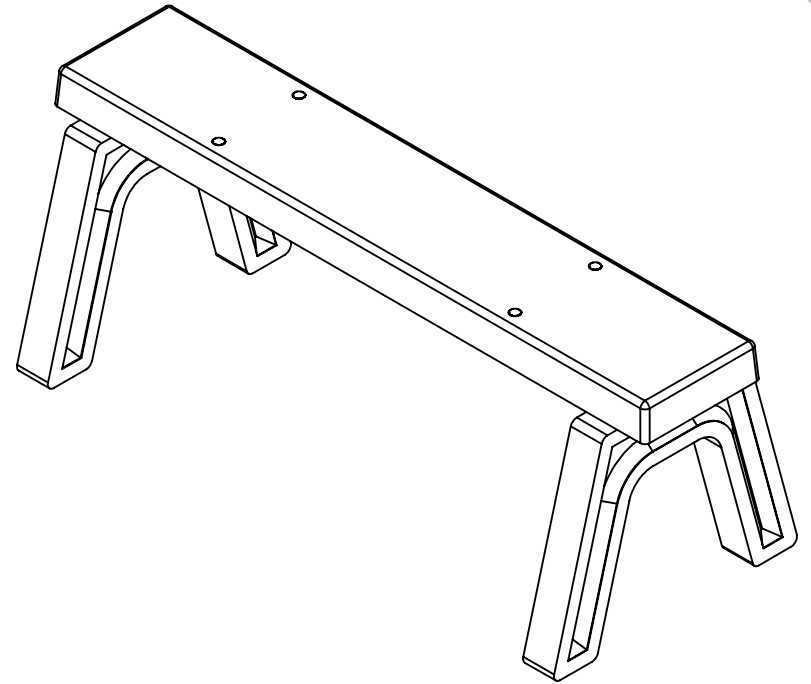
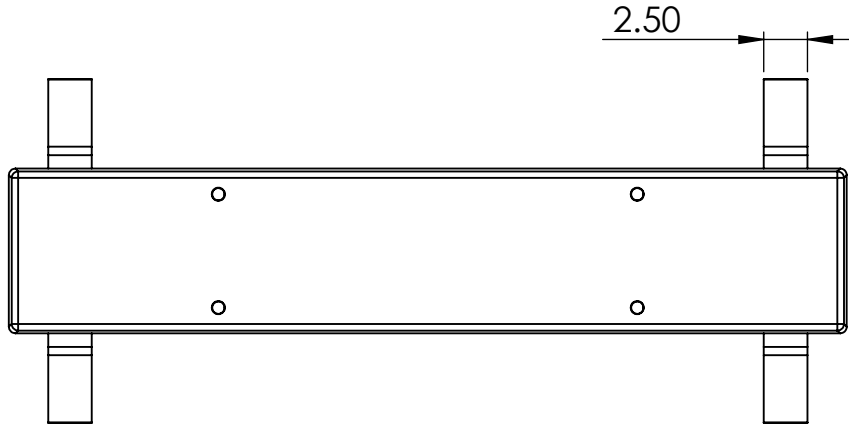

**CONSTRUCTION MATERIALS:**  
Plastic  
**HARDWARE:**  
Stainless Steel